

**MAXIMUM PRODUCT LOAD RATING: 100 kg** 

**IMPORTANT:**

- **LOAD = WEIGHT OF PLATFORM or BARS + MOUNTING SYSTEM + ACCESSORIES + CARGO**
- **PLEASE REFER TO VEHICLE MANUFACTURER SPECIFICATIONS FOR MAX ROOF LOAD CAPACITY OF VEHICLE. THE LOWEST LOAD RATING APPLIES.**
- **OFFROAD RATING: SCAN QR CODE FOR LOCKNLOAD LOAD RATING GUIDE. REDUCTIONS MAY APPLY.**



### FIRST TIME INSTALLATION

- Please read instructions carefully before installation.
- Check the contents of kit. Each LockNLoad RuggedLine has the last four digits of the kit's part number lasered in. Contact your YAKIMA dealer if any parts appear missing, incorrect or damaged.
- Clean your roof thoroughly prior to fitting the LockNLoad RuggedLine.
- Place these instructions in the vehicle's glove box after installation is complete.



**TOOLS REQUIRED:**

- 10 mm Socket Wrench
- Trim Removal Tool

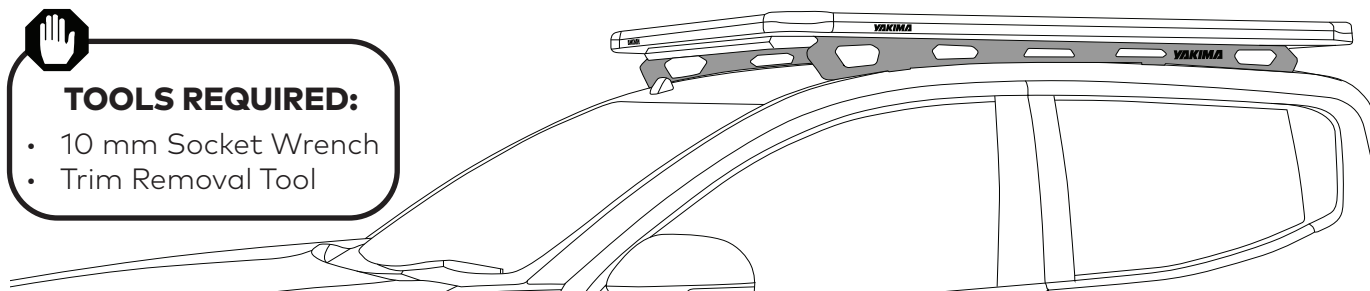

### KIT CONTENTS

ITEM	COMPONENT	QTY	ITEM	COMPONENT	QTY
1.	Triton Gen6 RuggedLine RH 1023	x1	9.	M6 Washer	x14
2.	Triton Gen6 RuggedLine LH 1023	x1	10.	M6 x 16 mm Button Head Cap Screw with Captive Washer	x2
3.	Pivot Bracket	x4	11.	4 mm T-Handle Ball End Allen Key	x1
4.	M8 x 20 mm Socket Head Cap Screw	x4	12.	5 mm T-Handle Ball End Allen Key	x1
5.	M8 Washer	x8	13.	6 mm T-Handle Ball End Allen Key	x1
6.	M8 Nut Nyloc	x4	14.	Ditch Mould Trim RH	x1
7.	M6 x 16 mm Socket Head Cap Screw	x12	15.	Ditch Mould Trim LH	x1
8.	M6 Spring Washer	x12			



**PLATFORM & COMPONENTS SOLD SEPARATELY  
RECOMMENDED PLATFORM SIZE IS 'K' (9820347)**

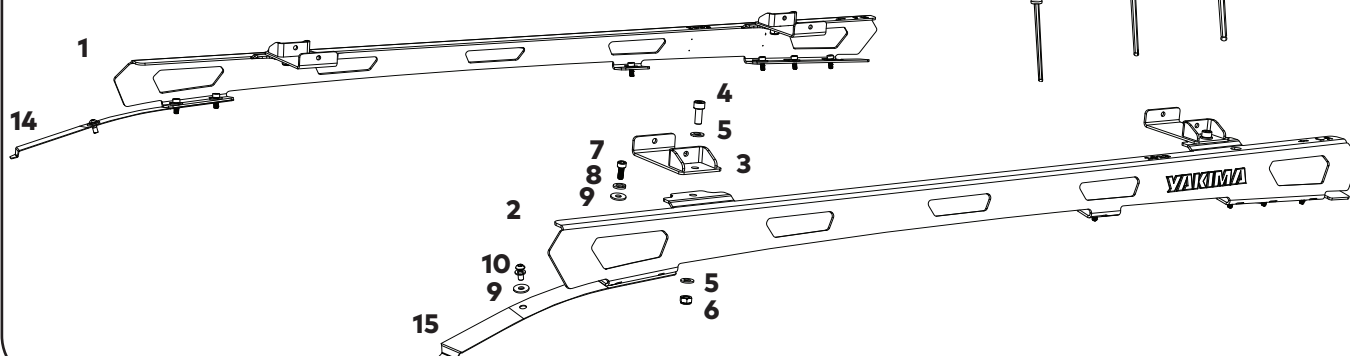
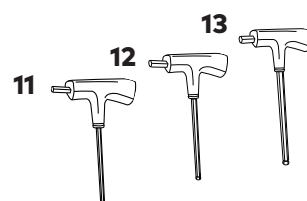

## REMOVING FACTORY FLUSH ROOF RAILS

1

### UNCLIP PLASTIC RAIL END COVERS.

Using an appropriate trim removal tool, wedge the rail covers upwards to release the internal clips.



Avoid touching vehicle body when levering covers.

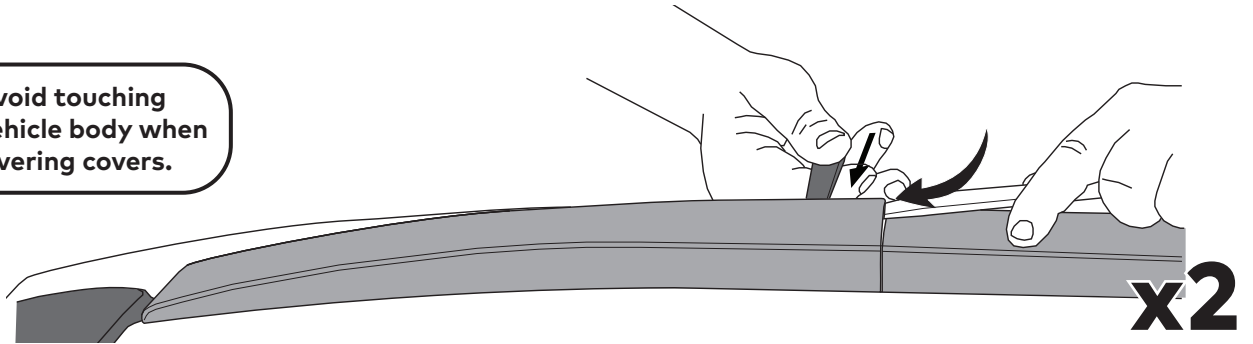

2

### LIFT PLASTIC RAIL COVERS.

Lift the outermost end of the front and rear covers up with caution. Lift outwards to avoid damage to rail.

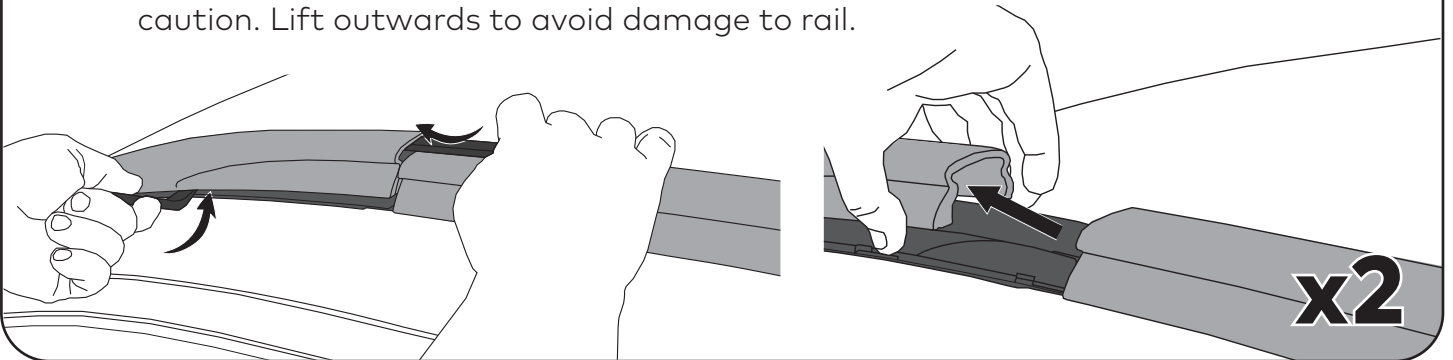

3

### LOOSEN BOLTS.

Remove exposed hardware (x2 bolts at front rail end and 3x bolts at rear rail end) using a 10 mm socket wrench.

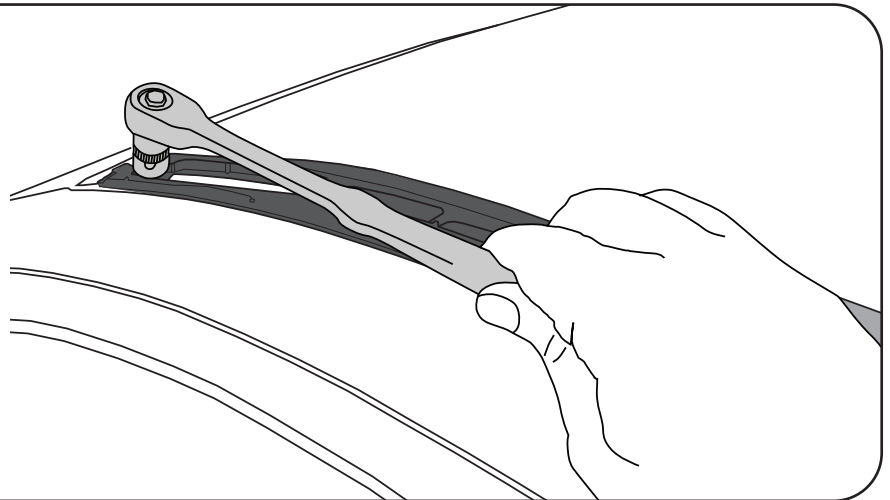

4

### REMOVE RAIL CAP.

Using a trim removal tool, remove the rail cap from the rail.

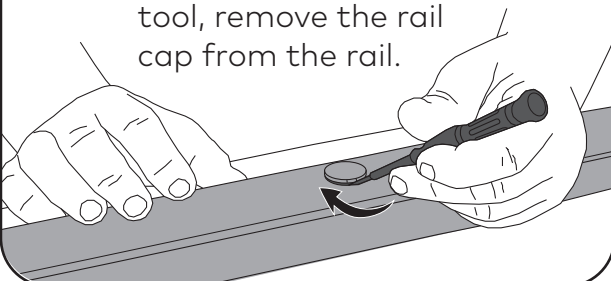

5

### LOOSEN BOLTS.

Loosen the now exposed bolt using a 10 mm socket wrench.

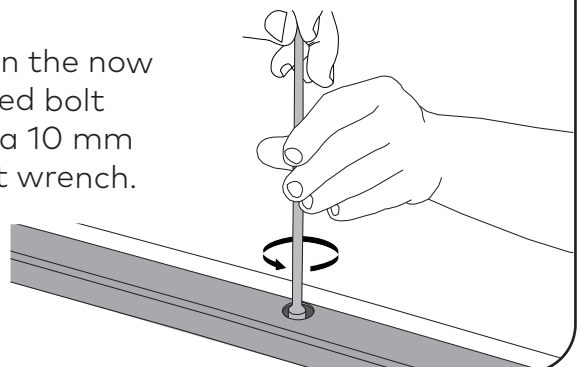

## 6 REMOVE RAIL.

Lift roof rail upwards and carefully remove from the roof.

Store all removed rail components and hardware away in a safe place.

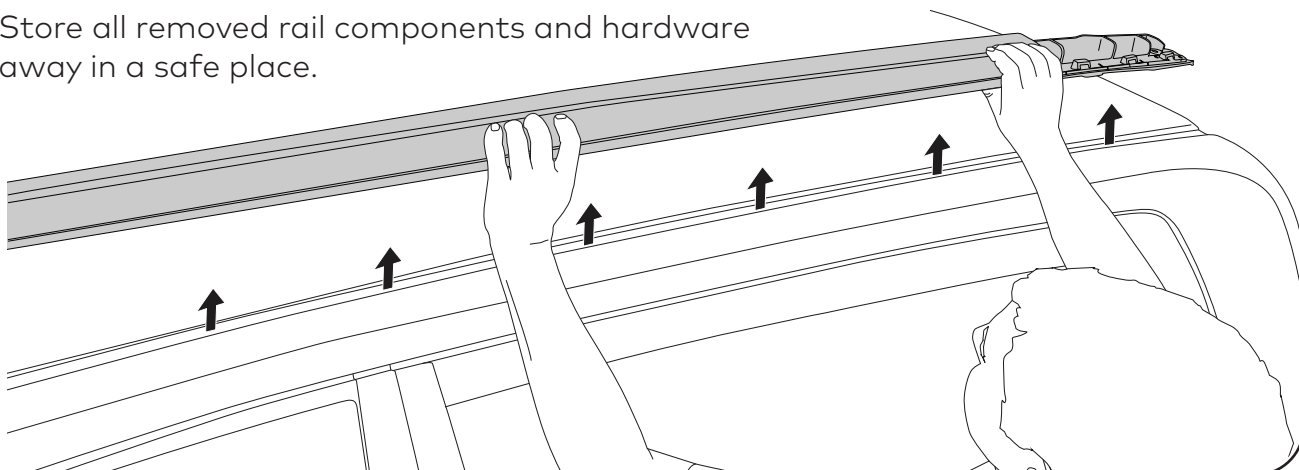

**REPEAT STEP 1-6 ON THE OPPOSITE SIDE OF THE VEHICLE.**

## 7 DITCH MOULD COVER.

Position the front ditch mould cover by slipping the front lip under the windscreen as shown.

Secure using the 4 mm T-handle ball end allen key, M6 x 16 mm button head cap screw with captive washer and 1 x M6 washer.

Tighten to 4 Nm.

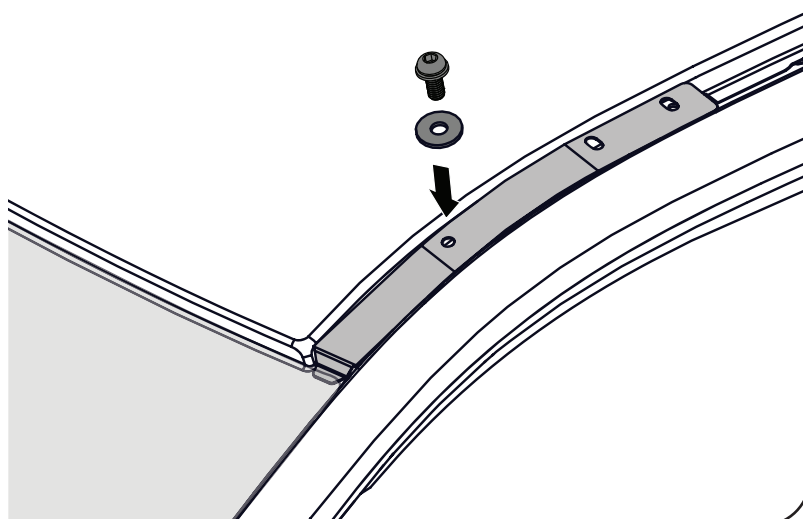

## 8 POSITION RUGGEDLINE ON VEHICLE ROOF.

Referring to the left-right orientation on top of each RuggedLine, carefully place one side of the RuggedLine onto vehicle roof on top of ditch mould cover. Line up the mounting holes on the bottom tabs to those exposed on the roof. The tabs are to face in towards the vehicle.

Front of vehicle

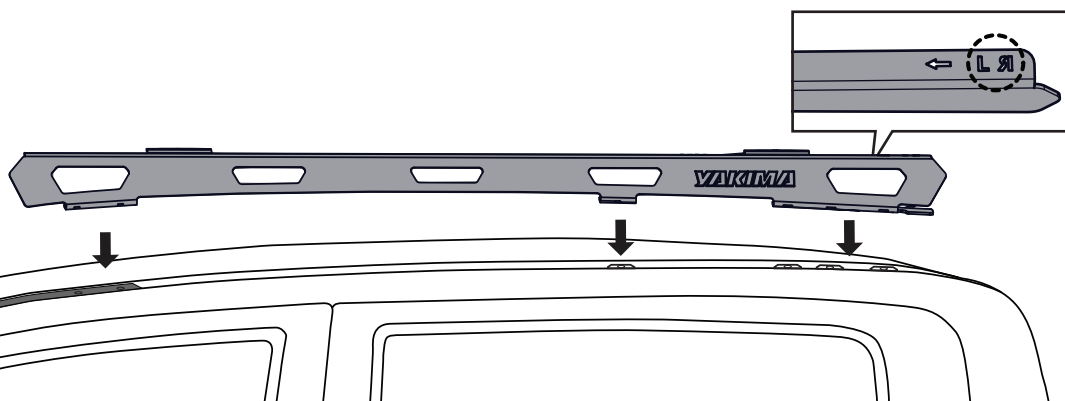

## 9 ASSEMBLE RUGGEDLINE HARDWARE.

Assemble the M6 x 16 mm socket head cap screw, M6 spring washer and washer as shown and place into mounting holes on bottom tabs of RuggedLine.

Ensure hardware and holes align with the holes on roof.

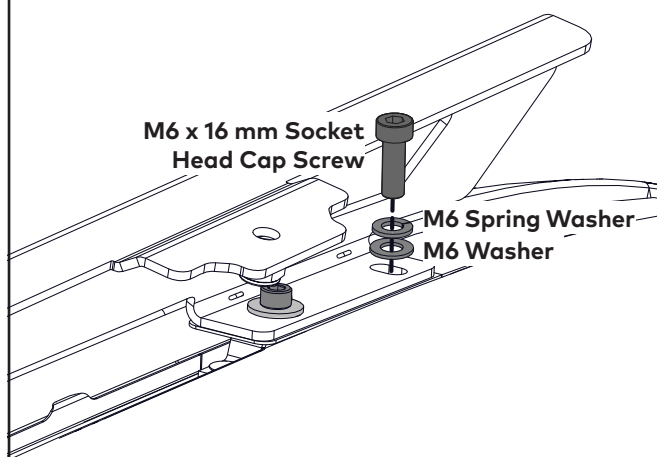

**x6**

## 10 TIGHTEN RUGGEDLINE HARDWARE.

Using the 5 mm T-handle ball end allen key, and avoiding damage to the powder coat, start to carefully secure the RuggedLine by tightening the M6 socket head cap screws to 7 Nm into the mounting holes in roof.

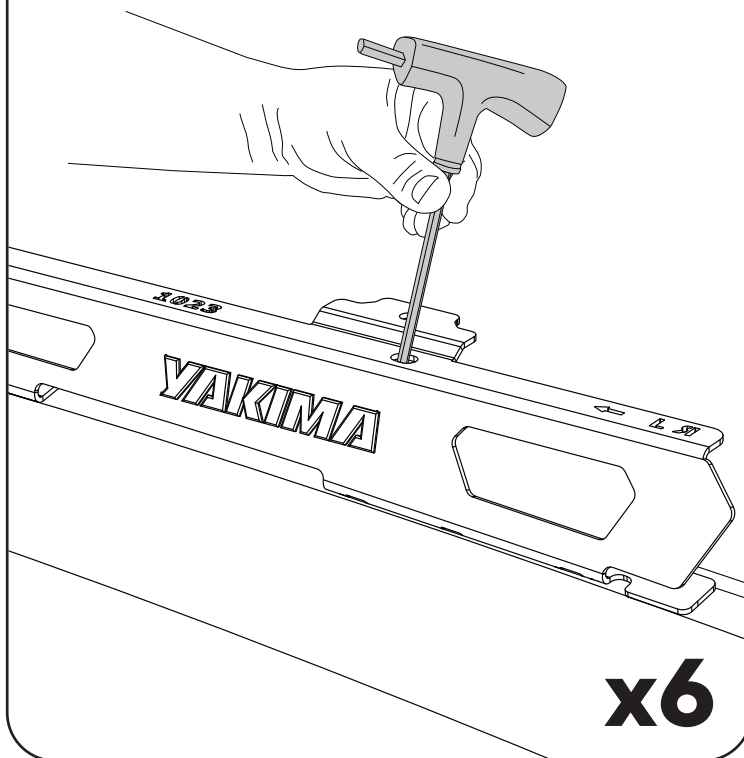

**x6**

## 11 REPEAT STEPS TO OPPOSITE SIDE.

Repeat steps 7-10 for securing opposite side of RuggedLine.

Ensure both RuggedLine are securely positioned on the vehicle roof. Check each screw is secure before proceeding to install LockNLoad platform to RuggedLine.

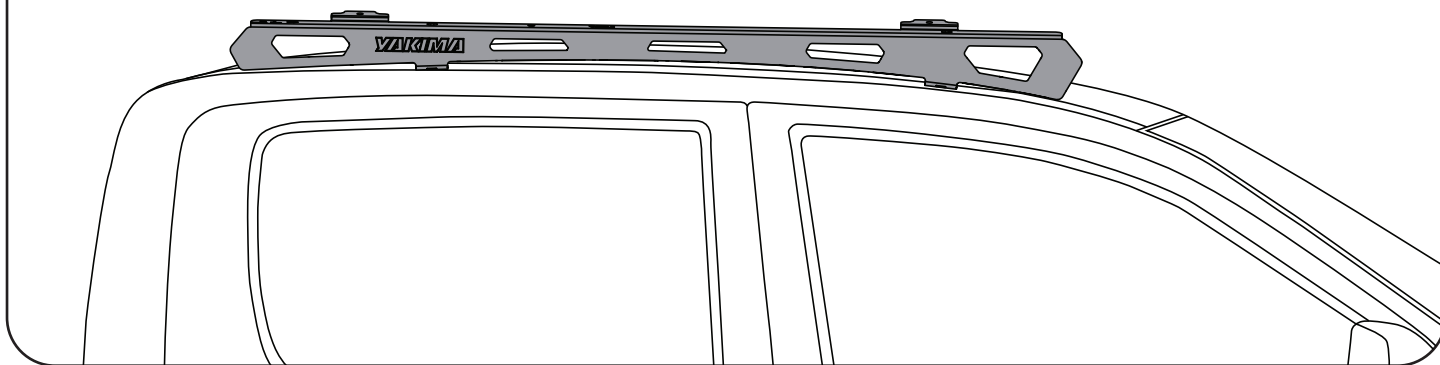

**12****PIVOT BRACKET ASSEMBLIES.**

Retain the 6 mm T-handle ball end allen key and not yet installed pivot brackets, M8 x 20 mm socket head cap screws, M8 nyloc nuts and M8 washers.



These components will be required for mounting your LockNLoad platform to your newly installed RuggedLine.

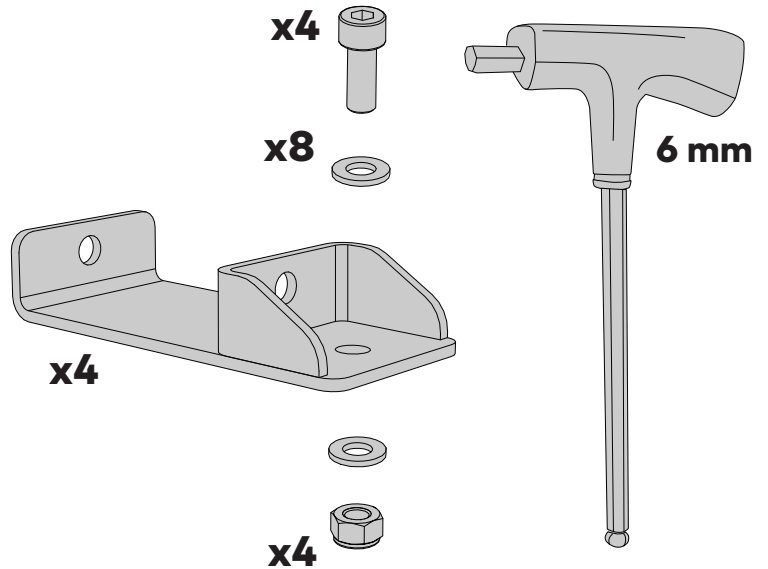

**NOW SWITCH TO YOUR LOCKNLOAD PLATFORM  
INSTRUCTIONS AND CONTINUE FROM THE  
'RUGGEDLINE MOUNTING INSTRUCTIONS' PAGE.**



[www.yakima.com.au](http://www.yakima.com.au)  
[www.yakima.co.nz](http://www.yakima.co.nz)  
[www.yakima.com](http://www.yakima.com)  
[www.yakima.eu](http://www.yakima.eu)

**YAKIMA AUSTRALIA PTY LTD**

17 Hinkler Court  
Brendale, QLD 4500  
Australia  
1800 143 548  
[yakima.com.au/contact-us](http://yakima.com.au/contact-us)

**YAKIMA PRODUCTS, INC.**

4101 Kruse Way  
Lake Oswego, OR  
97035-2541  
USA  
888 925 4621  
[yakima.com/support](http://yakima.com/support)