

# YAKIMA TreadPlate

1

Remove lug nuts and tire.

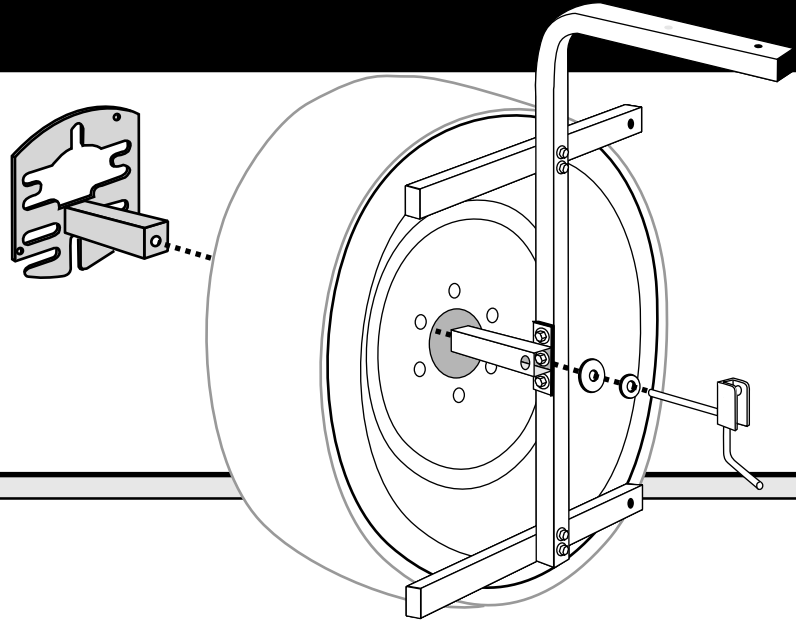

2 Hang TreadPlate on tire mounting bolts or spare hanger.

When installing TreadPlate on tire mounting bolts, first determine which orientation works best for your vehicle.

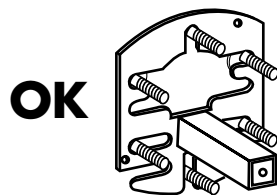

Any combination of slots can be used.

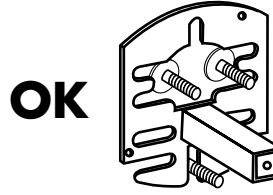

Bolts need not engage into slots on all fits.

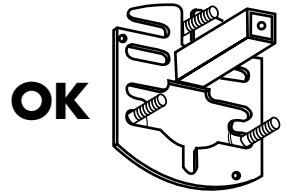

TreadPlate can be rotated 180°.

3

Re-install spare tire over plate and tighten lug nuts securely.

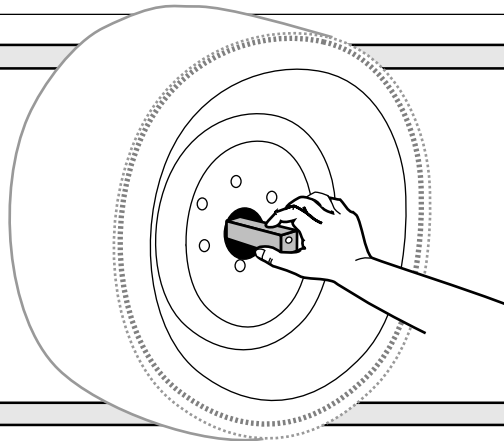

Some applications may require that you hold TreadPlate in place while tightening lug nuts so it does not come in contact with rim.

4

Attach crank:

Note: An underinflated tire can cause poor contact between TreadHead and tire. Loosen crank before inflating.

Unfold the crank.

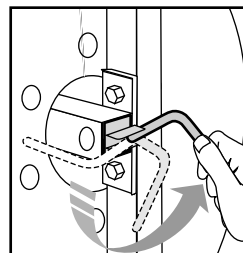

Tighten by turning.

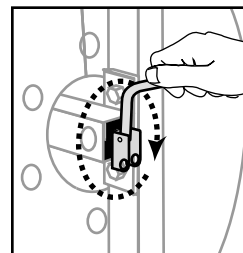

Close the crank.

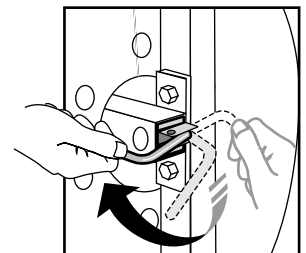

# YAKIMA Plaque TreadPlate

**1**

Dévisser les écrous et déposer la roue de secours.

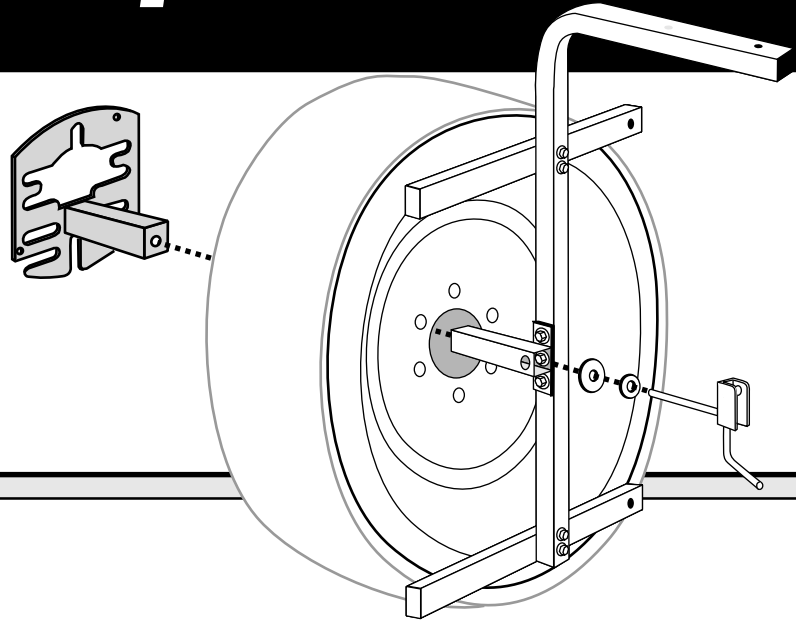

**2** Engager la plaque TreadHead sur les boulons de la roue de secours.

Pour poser la plaque TreadPlate sur les boulons de la roue de secours, déterminer d'abord le sens qui convient le mieux pour le véhicule.

**OK**

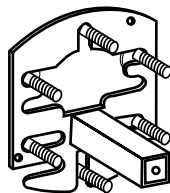

On peut employer n'importe quelles fentes.

**OK**

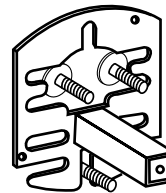

Il n'est pas obligatoire que les boulons soient dans les fentes.

**OK**

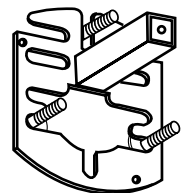

On peut pivoter la plaque de 180°.

**3**

Remettre la roue en place par-dessus la plaque et bien serrer les écrous.

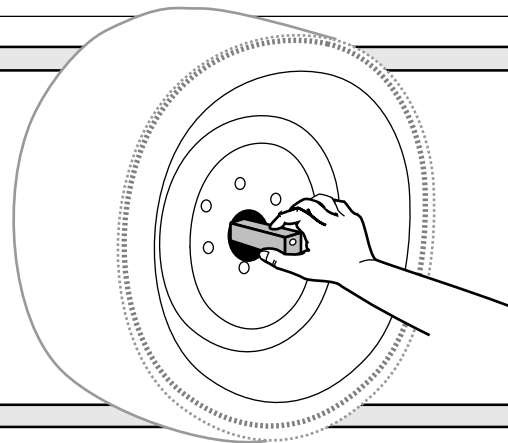

Dans certains cas, il faut tenir la plaque en place pendant qu'on serre les écrous pour qu'elle ne touche pas à la roue.

**4**

Attacher le levier coudé:

Remarque: Si le pneu est insuffisamment gonflé, le porte-vélo risque de mal porter contre le pneu.

Desserrer la manivelle avant de gonfler le pneu.

Déplier la manivelle.

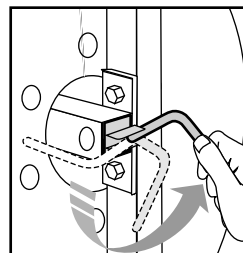

Tourner la manivelle pour serrer.

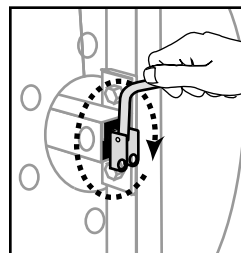

Replier la manivelle.

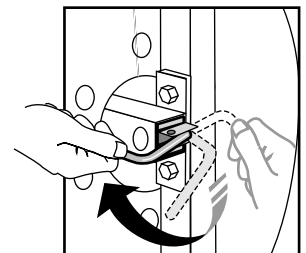

Consulter les instructions qui accompagnent le porte-vélos TreadHead verrouillable pour connaître les dispositions de la garantie limitée Yakima.