

MAXIMUM PRODUCT LOAD RATING: 100 kg 

IMPORTANT:

- **LOAD = WEIGHT OF PLATFORM or BARS + MOUNTING SYSTEM + ACCESSORIES + CARGO**
- **PLEASE REFER TO VEHICLE MANUFACTURER SPECIFICATIONS FOR MAX ROOF LOAD CAPACITY OF VEHICLE. THE LOWEST LOAD RATING APPLIES.**
- **OFFROAD RATING: SCAN QR CODE FOR LOCKNLOAD LOAD RATING GUIDE. REDUCTIONS MAY APPLY.**



FIRST TIME INSTALLATION

- Please read instructions carefully before installation.
- Check the contents of kit. Contact your YAKIMA dealer if any parts appear missing or damaged.
- Clean your roof thoroughly prior to fitting the LockNLoad Track Heavy Duty Roof Rack System.
- Place these instructions in the vehicle's glove box after installation is complete.



TOOLS REQUIRED:

- Marking Pen
- Tape Measure
- Masking Tape
- Drill Bit Stop
- Vacuum Cleaner
- Hammer
- Rivet Gun
- Scissors
- Centre Punch
- Fine Tooth Hacksaw
- Automotive Adhesive
- Zinc Rich Cold Galvanising Coating
- Automotive Degreaser
- Power or Cordless Drill
- Flat Blade Screwdriver
- 10 mm Open Ended Spanner
- 13 mm Socket or Spanner
- Thread Locking Compound
- Rubber Mallet (Optional)
- #2 Phillips Head Screwdriver
- Mastic Silicone Sealant

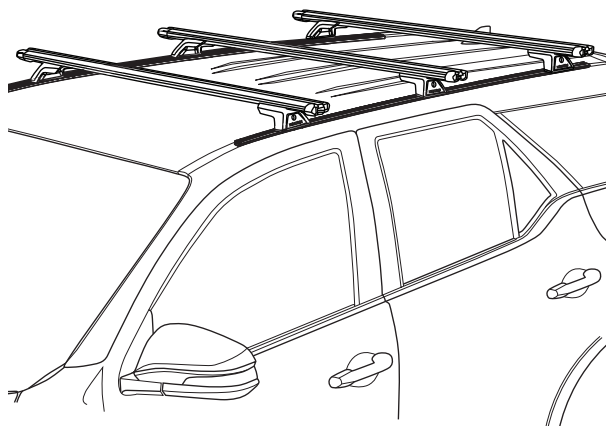

KIT CONTENTS

ITEM	COMPONENT	QTY	ITEM	COMPONENT	QTY
1.	Track Toyota Fortuner Right Hand Side	x1	7.	Drill Bit	x1
2.	Track Toyota Fortuner Left Hand Side	x1	8.	M6 Hex Screw 20 mm	x8
3.	Track Nut Plate	x6	9.	M6 Hex Screw 30 mm	x4
4.	M6 Washer	x12	10.	End Cap Front Left & Rear Right	x2
5.	M6 Spring Washer	x12	11.	End Cap Front Right & Rear Left	x2
6.	Rivet	x18	12.	LockNLoad Height Packer	x4



LEG AND BAR COMPONENTS SOLD SEPARATELY

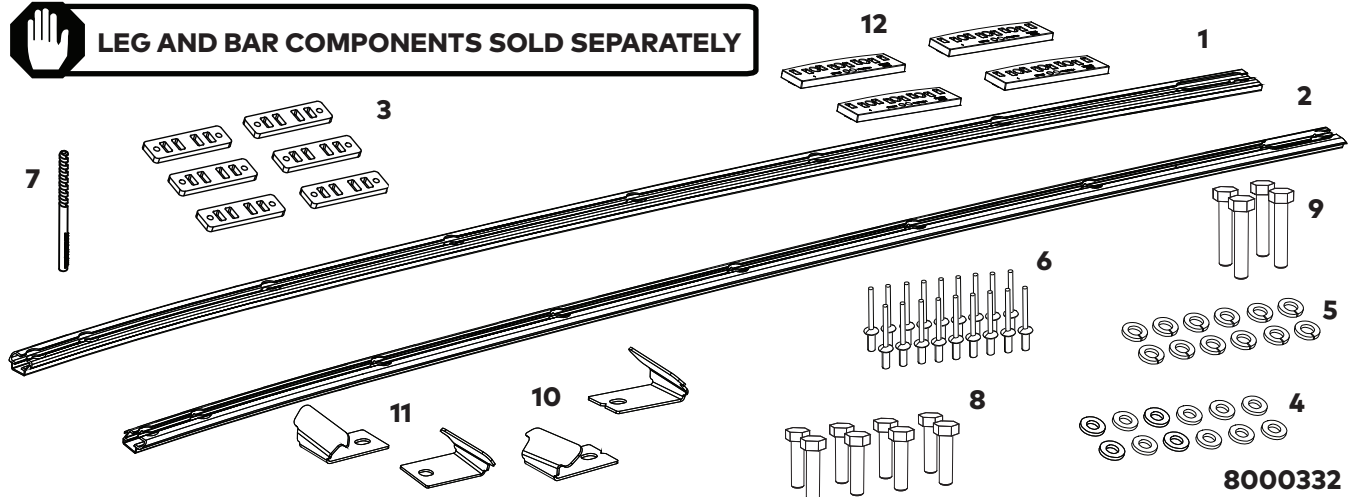

TRACK INSTALLATION

1 BEFORE BEGINNING INSTALLATION

Clean roof thoroughly and allow to dry before beginning installation.

REMOVE ROOF CHANNEL TRIM

Gently lever the rubber roof channel trim with a Flat Blade Screwdriver (wrap tape around end of Screwdriver to prevent paint scratching). Then using fingertips pull carefully upwards and unhook plastic clips that are attached to the roof underneath each end of the trim.

Store channel trim in a safe location for use in Step 14.

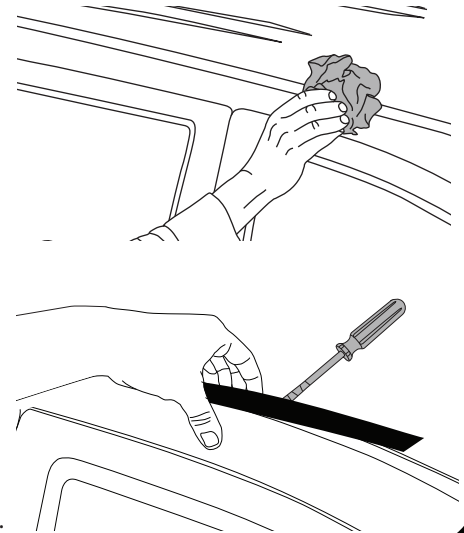

2 TRACK ORIENTATION

The extrusion on side of Tracks faces **inside of vehicle** as shown, with rounded rectangular cut outs at rear of vehicle.

The help of an assistant is recommended to install Tracks.

It is recommended to install one Track at a time.

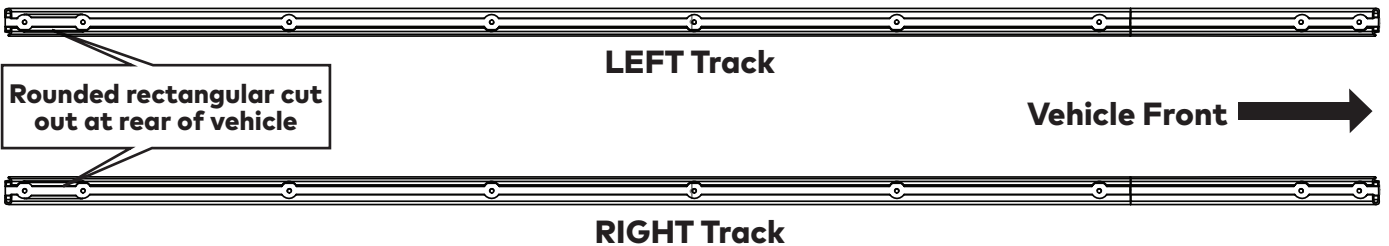
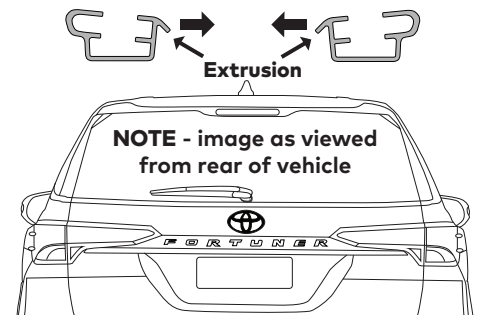

NOTE - image as viewed from above

3 TRACK MEASUREMENTS

Apply Masking Tape along roof channel. Using a Tape Measure, measure 350 mm back from the edge of the windscreen as shown and record.

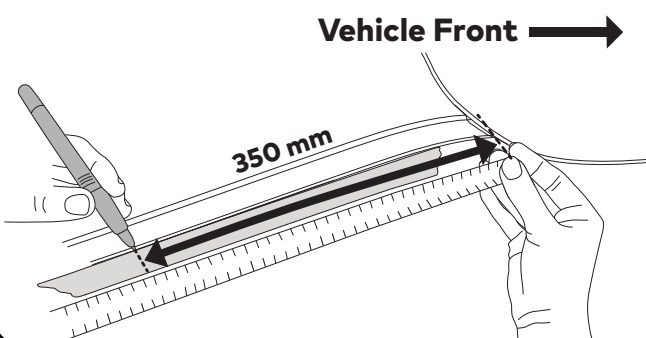

4 APPLY MASKING TAPE

Apply lengths of Masking Tape along window and door seals.

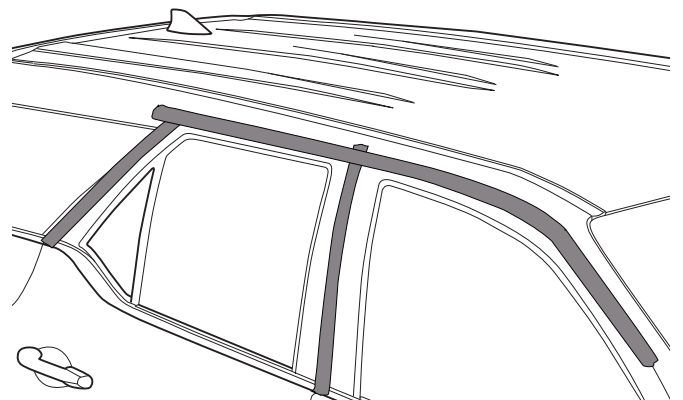

NOTE - This prevents drill swarf from getting caught.

5 ALIGN TRACK INTO ROOF CHANNEL

Place Track into roof channel, lining up the front of the track end with the tape line measured in Step 3. Ensure Track orientation and spacing is correct as shown, with rounded rectangular cut outs at rear of vehicle.

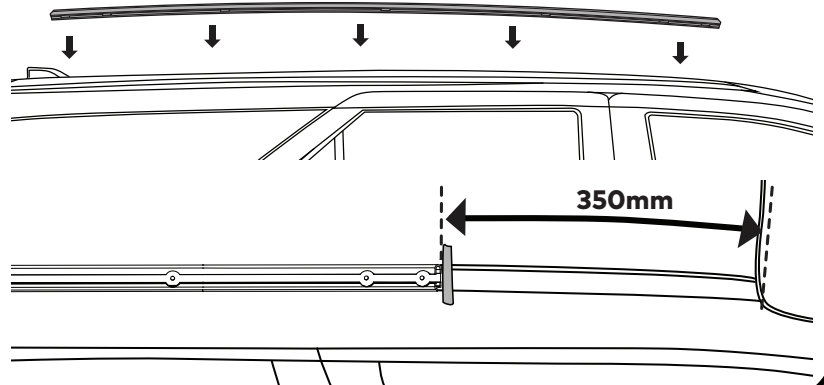
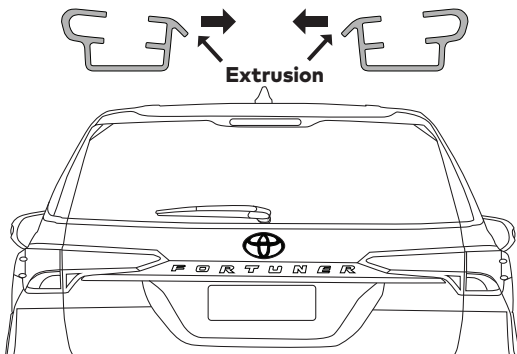

6 MARK TRACK HOLES

With the help of an assistant, hold Track down firmly in roof channel and mark all holes using a Marking Pen. Ensure Track does not move during this process. Remove Track.

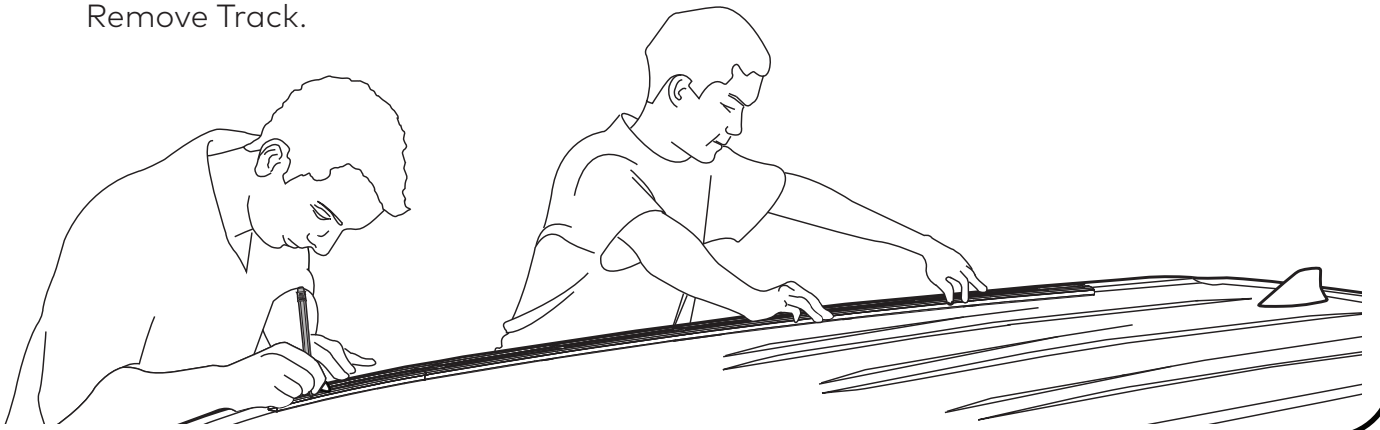

7 CENTRE PUNCH HOLES

Using a Centre Punch and Hammer, accurately Centre Punch the holes marked in the previous Step.

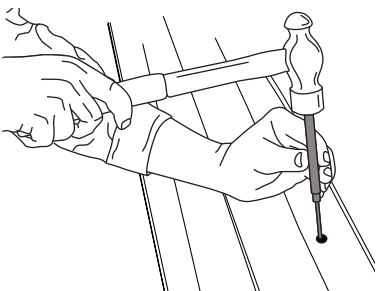

8 DRILL ROOF

Using the 4.9 mm Drill Bit provided and a Drill Stop which allows a drill depth of 6-8 mm, carefully drill through the roof at each centre marked location. Ensure a drilling angle perpendicular to the roof surface is maintained throughout.

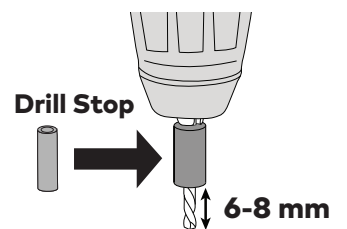

Vehicle Front

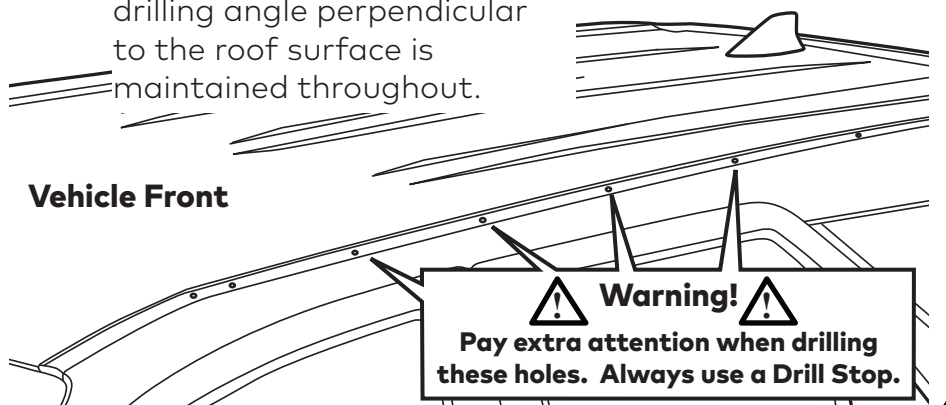

Warning!
Pay extra attention when drilling these holes. Always use a Drill Stop.

9 REMOVE SWARF

Avoid pushing swarf into the newly drilled holes by removing swarf from roof channel with a Vacuum Cleaner.

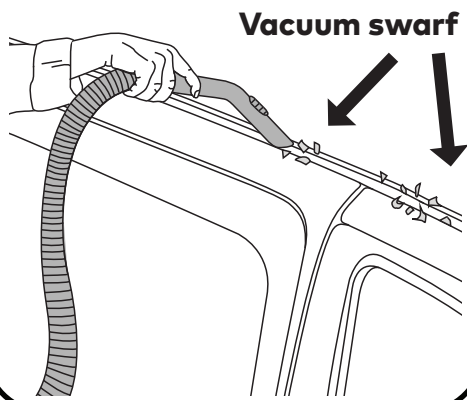

10 APPLY PROTECTIVE SEALANTS

Stage 1

Liberaly apply a Zinc Rich Cold Galvanising Solution to the inside surface and surrounds of each drilled hole. Allow solution to become touch dry before proceeding with Stage 2 (approx. 10 min depending on product used).

Stage 2

Liberaly apply a Mastic Silicone Sealant to the inside surface and surrounds of each hole.

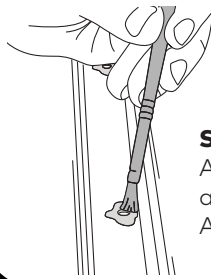

Stage 1

Apply liberaly in and around holes. Allow to dry.

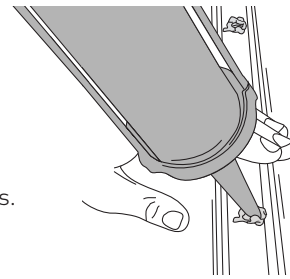

Stage 2

Apply liberaly in and around holes.

11 PLACE TRACKS BACK INTO ROOF CHANNEL

Accurately place Tracks over drilled holes in roof channel, ensuring Track orientation is correct as shown, with rounded rectangular cut outs at rear of vehicle.

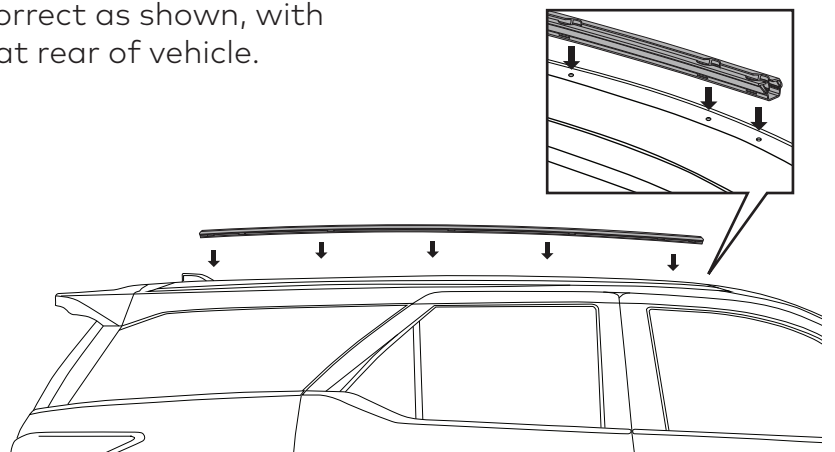
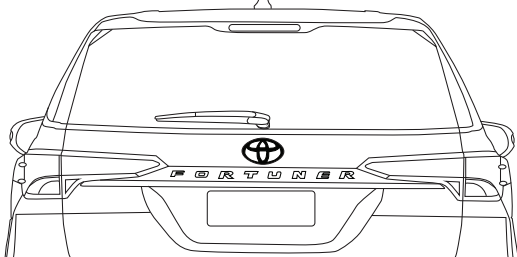

12 END CAP FITMENT

Assemble End Caps within Tracks as shown, taking note of End Cap orientation.

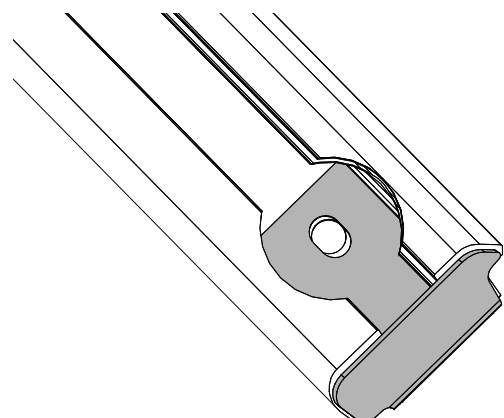
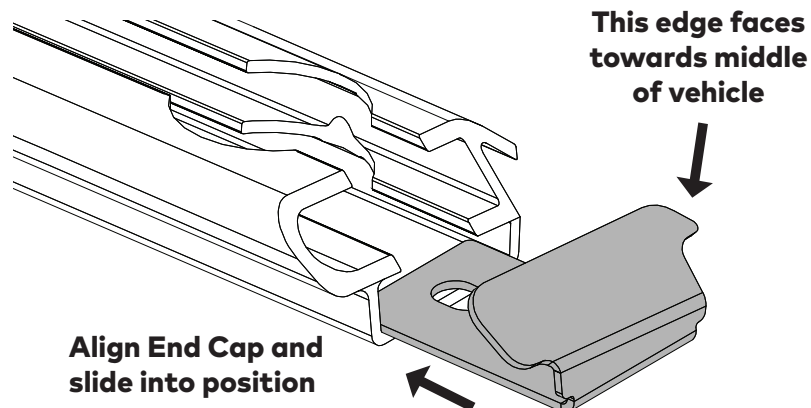
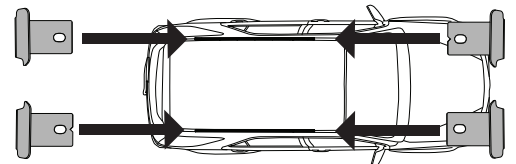

13

TRACK INSTALLATION

Align Track and secure End Caps by inserting all Rivets in their respective holes through Track into roof channel.

Using a Rivet Gun, activate each Rivet starting from the centre Rivet, then working consecutively outwards as shown.



Vehicle Front →

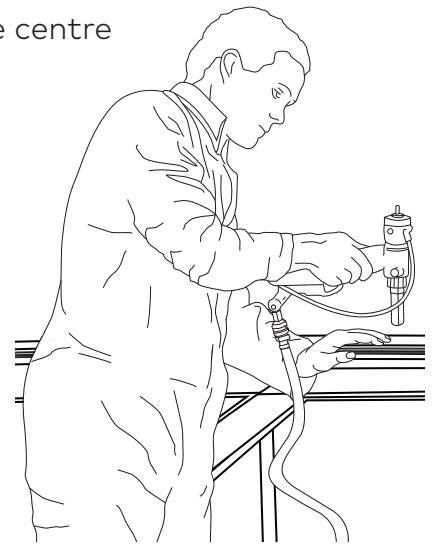
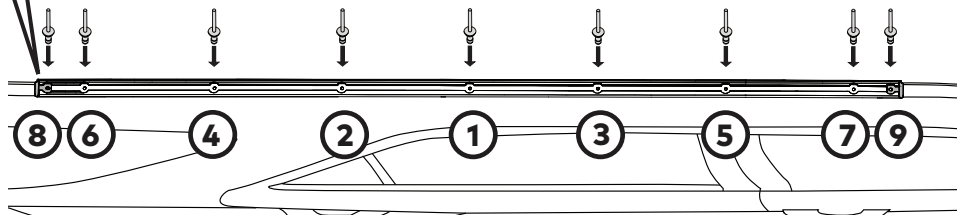

14

CUT ROOF CHANNEL TRIM TO SIZE AND REFIT

Thoroughly clean exposed roof channel at front and rear of Tracks using an Automotive Degreaser before refitting roof trim.

To conceal exposed roof channel at front and rear of Tracks, cut to length the original roof trim removed in Step 1.

Measure out the required length by positioning the trim along roof channel. The front needs to be measured so the end of trim sits under windscreen rubber.

Use a pencil to mark reference line on trim. Remove trim from vehicle and cut to length using a Fine Tooth Hacksaw.

Liberaly apply an Automotive Adhesive to roof channel then refit trim pieces. Wipe off any excess adhesive with a damp cloth and allow to dry.

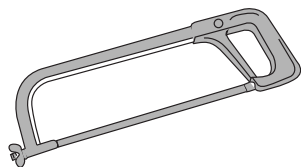

Use a fine tooth Hacksaw due to metal inside rubber roof trim. Alternatively tin snips can be used

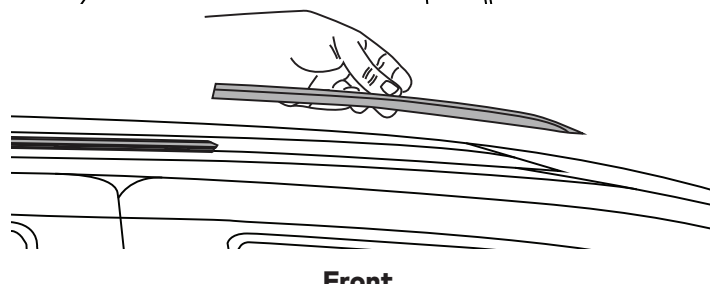
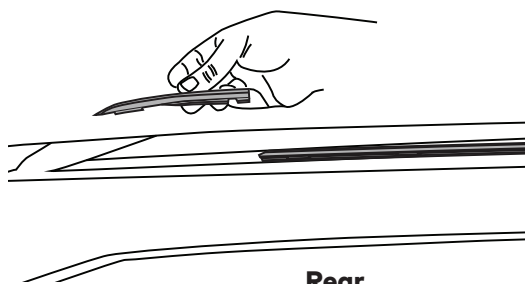

15**TRACK INSTALLATION COMPLETE**

Check both Tracks are secured to the vehicle as per these installation instructions. For assistance contact your local Yakima dealer.

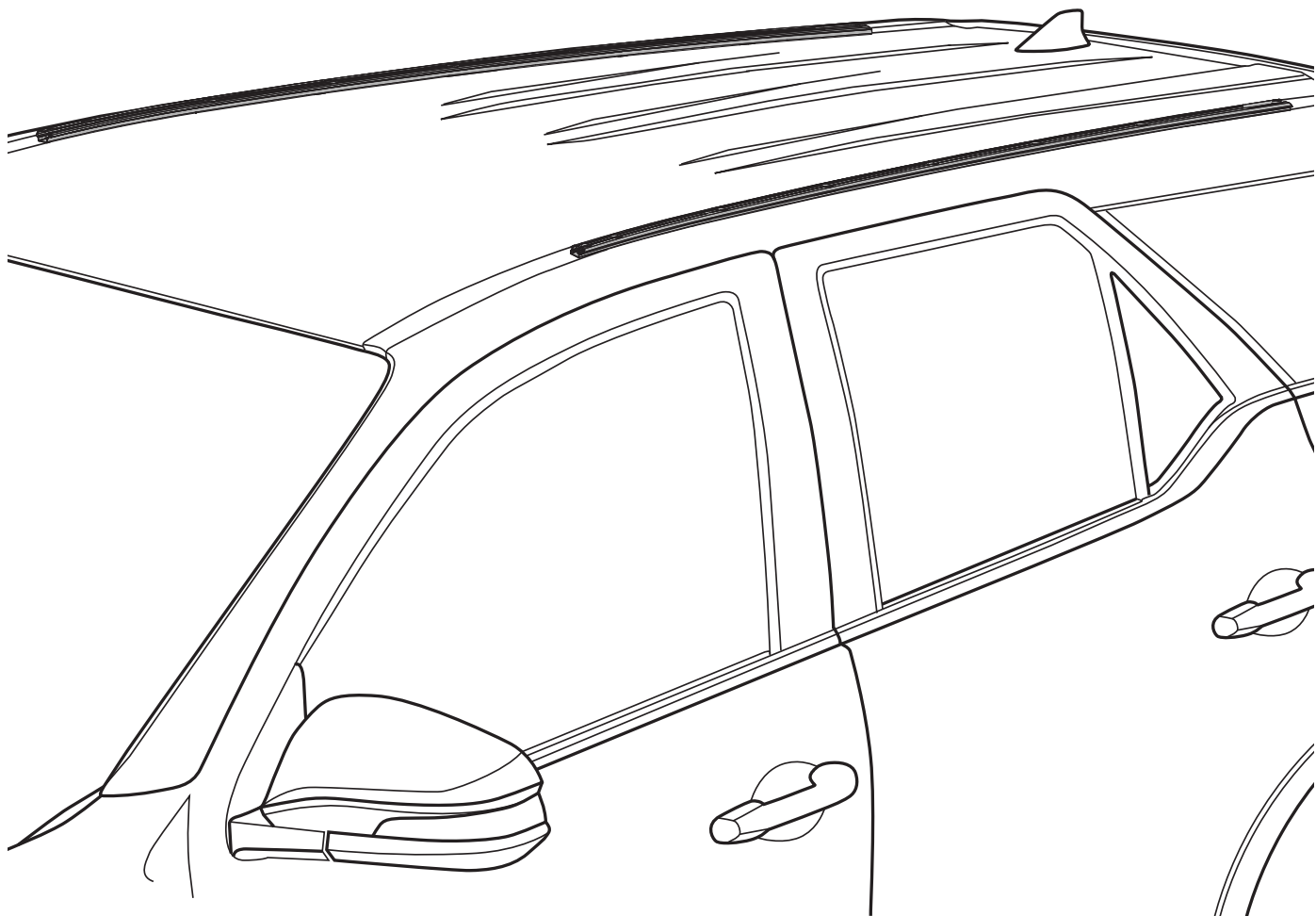

IF INSTALLING LOCKNLOAD ROOF RACKS, CONTINUE ON TO STEP 16

IF INSTALLING A LOCKNLOAD PLATFORM, SWITCH TO YOUR PLATFORM INSTRUCTIONS

BAR INSTALLATION

16

REMOVE END CAPS FROM BARS

From the LockNLoad Bar Kit (sold separately), remove Plastite Screw from each Bar end using a #2 Phillips Head Screwdriver and pull out End Caps from Bars.

Keep all parts aside for later installation.

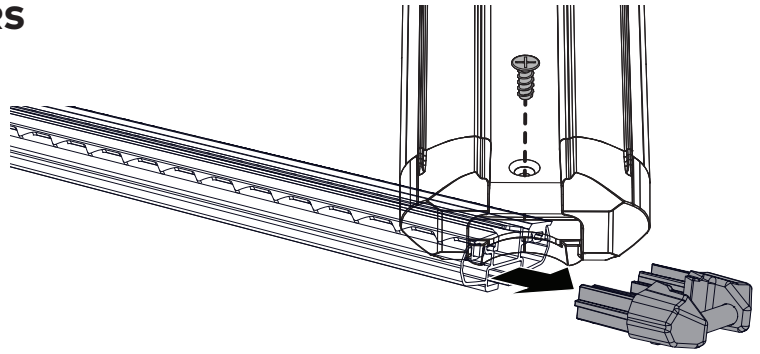

17

REMOVE LEG COVERS

Using the keys supplied in the LockNLoad Leg Kit (sold separately), remove all Leg Covers.

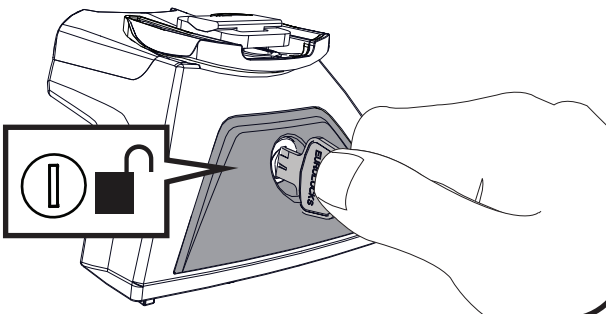

18

INSERT LEGS

Slide the pre-assembled Leg assemblies into the underside channel of LockNLoad Bars.

If Leg assemblies will not slide in, loosen Screws to increase gap.

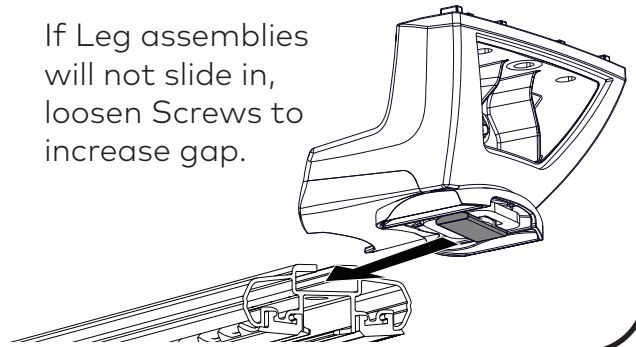

19

INSERT NUT PLATES

Run all M6 Hex Screws through Nut Plates to remove burrs.

Insert three (3) Nut Plates into each Track as shown.

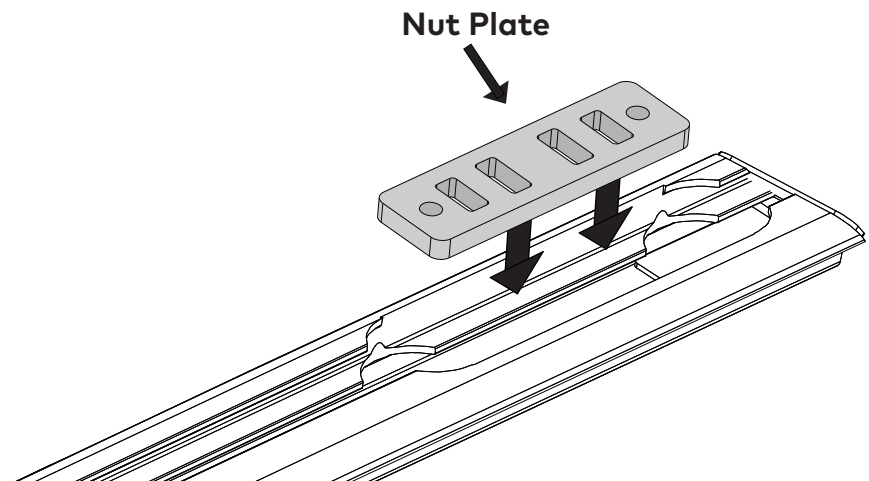
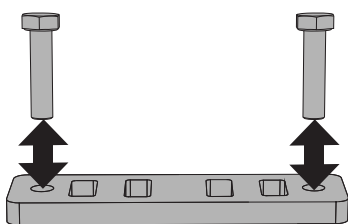

20

HEIGHT PACKER SET-UP

Height Packers are required to level the rear Bar on the vehicle roof.

The rear Bar requires 2 x Height Packers on each leg as shown.

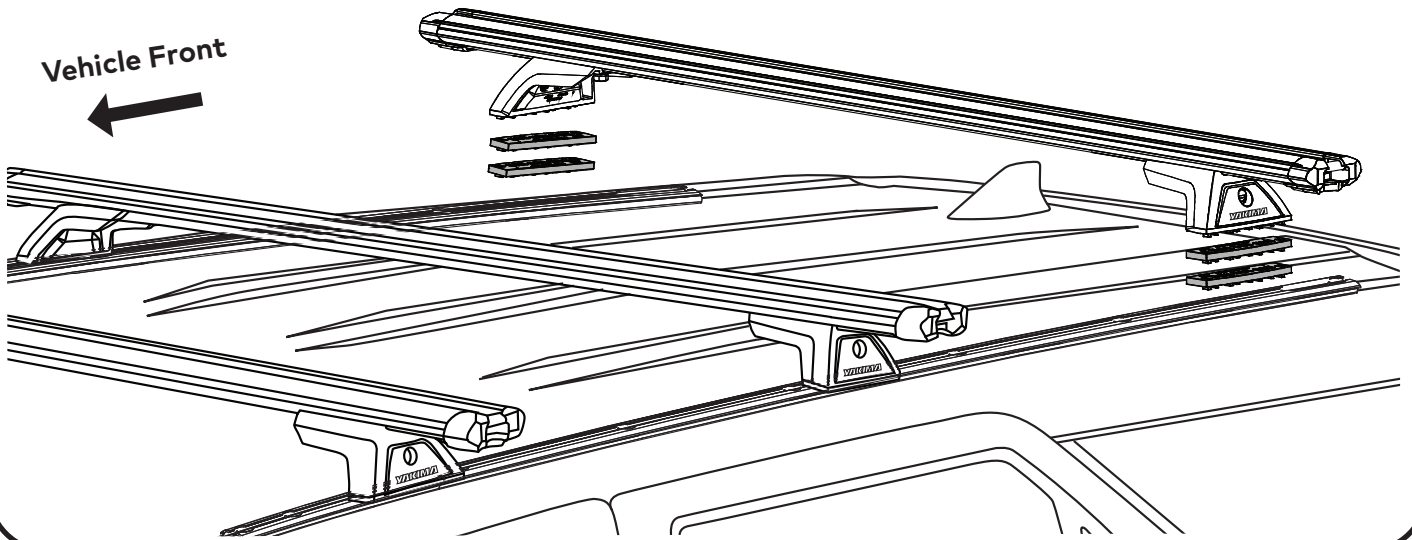

19

HEIGHT PACKER FITMENT

Fit Height Packers on top of Nut Plates, locating the raised notches on base of Height Packers into the cut outs as shown.

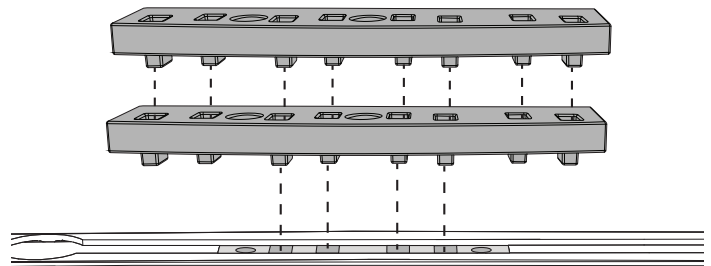

20

CROSSBAR SPACING

Refer to the below image for the recommended 3 Bar spacing.

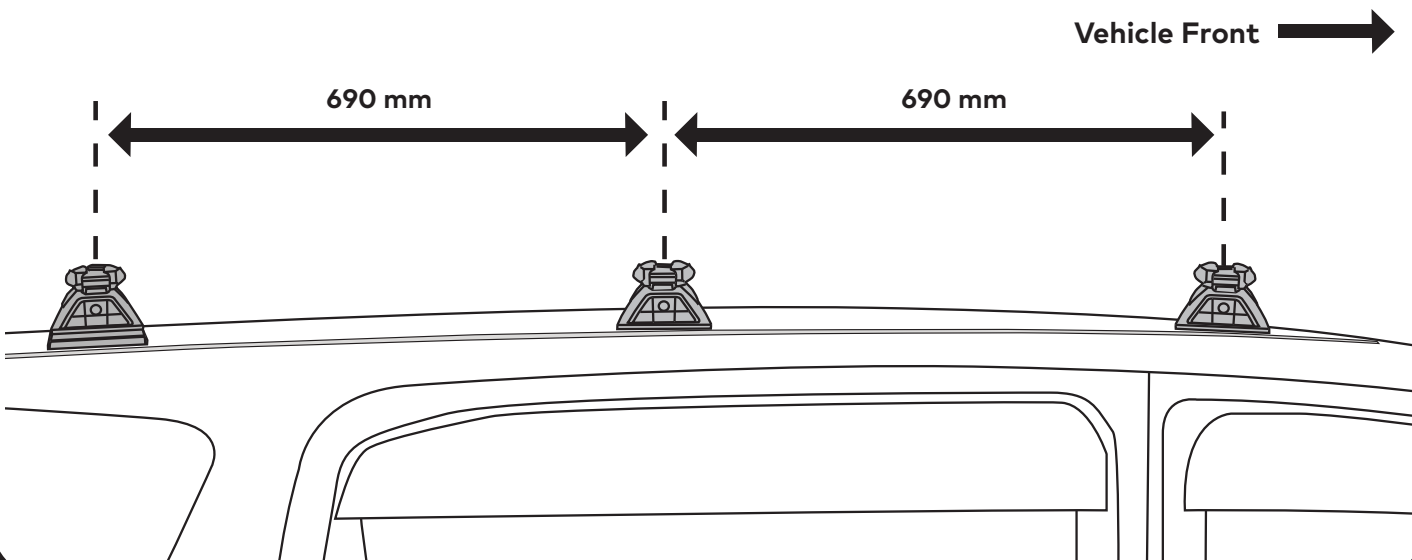

21**BAR PLACEMENT**

Carefully place front Bar assembly over Nut Plates, ensuring spacing is correct as shown in the previous Step. **Take care not to damage vehicle.** Position Legs along Bar until both legs are securely positioned on Nut Plates within Track.

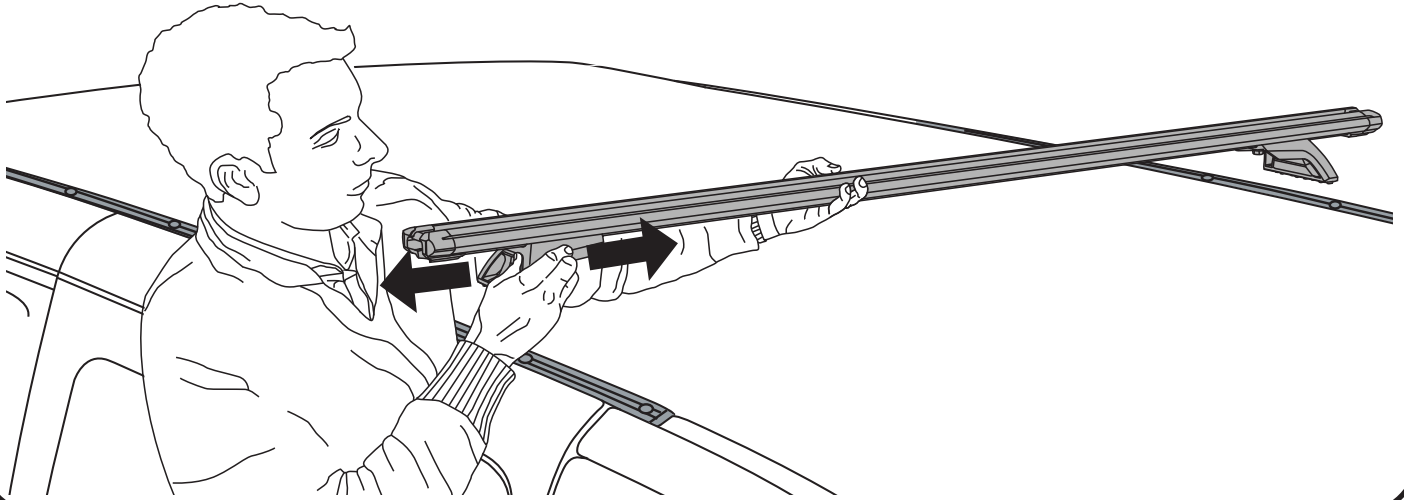
**22****SECURE BAR ASSEMBLY TO TRACKS**

From the LockNLoad Track Kit, insert the appropriate length M6 Hex Screw (refer to images below) through the two outer holes on Legs into Height Packers/Nut Plates as shown. Loosely secure Screws using a 5 mm ball end Allen Key.

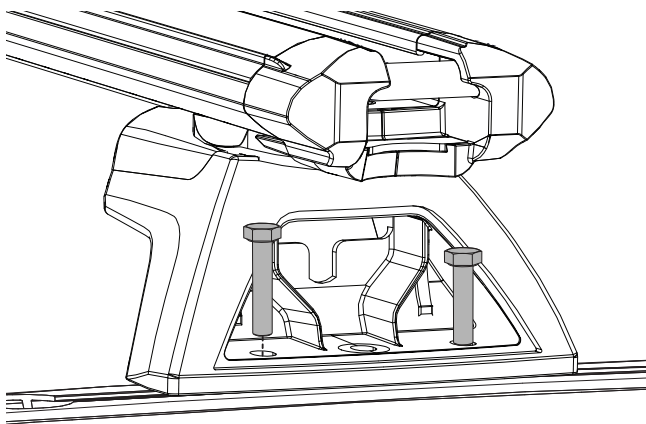

Front & Middle Legs | M6 Set Screw 20 mm

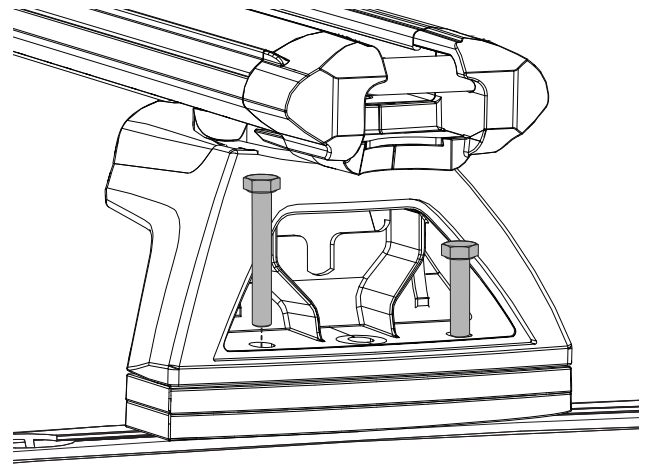

Rear Legs | M6 Set Screw 30 mm

23**ADJUST BAR OVER HANG**

Use a Tape Measure to ensure even Bar overhang on each side, re-adjust if required by sliding bar along tracks.

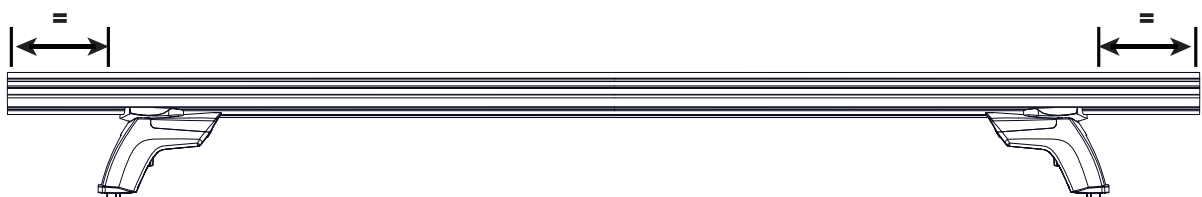

NOTE - Bars require individual adjustment due to tapered roof. Bars must be installed perpendicular to Tracks.

24**SECURE LEGS TO BARS**

Tighten all M8 Set Screws to 9 Nm using a 13 mm Spanner.

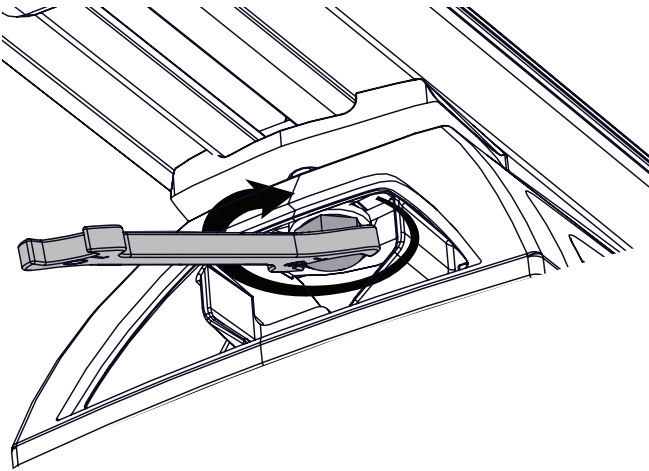
**25****REPEAT AND REMOVE**

Repeat Steps 21 - 24 for remaining bar assemblies.

Carefully remove all Bar and Leg assemblies from vehicle.

**26****CHECK BAR SLOT MEASUREMENTS**

Place Bars on flat surface with legs facing upwards, as shown. Take appropriate measures to avoid scratching the product and surface.

Identify slot on each Bar end. Using a Tape Measure, record Leg to underside slot distance of each bar in the table (right). Ensure measurement is taken from the centre of the Legs as shown.

BAR SLOT MEASUREMENTS
Bar 1 (X) _____mm x2
Bar 2 (Y) _____mm x2
Bar 3 (Z) _____mm x2

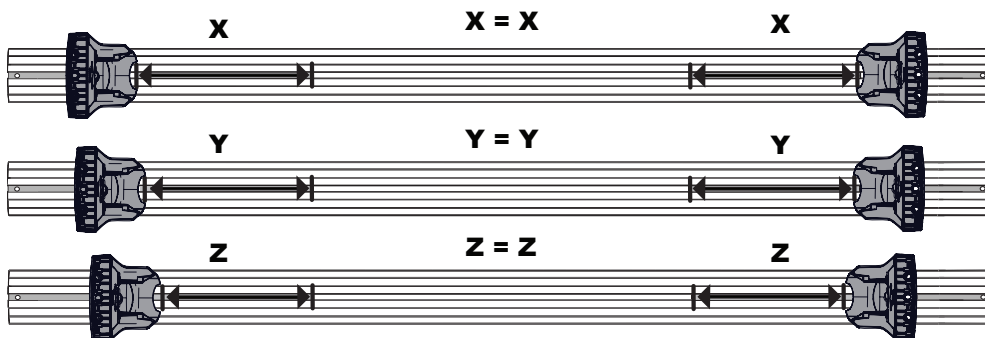

The ends of each bar should be the same measurement respectively, if not, loosen M8 Set Screws and repeat Steps 21-26.

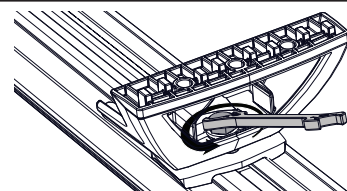

27**BAR SLOT COVERS (INSIDE LEG)**

From the LockNLoad Bar Kit, cut Bar Slot Covers as per measurements recorded in the previous Step and press into the underside channel of Bar ends as shown.

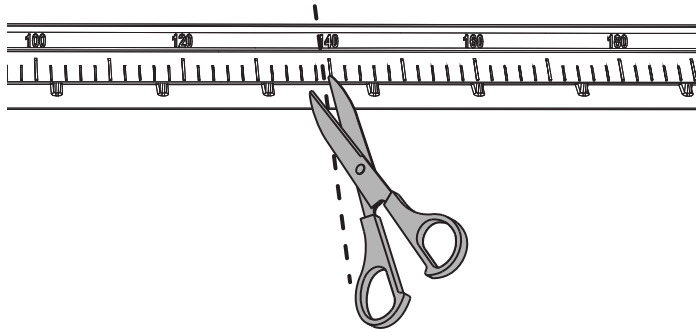

NOTE - Bar Slot Covers to be inserted with flat side visible

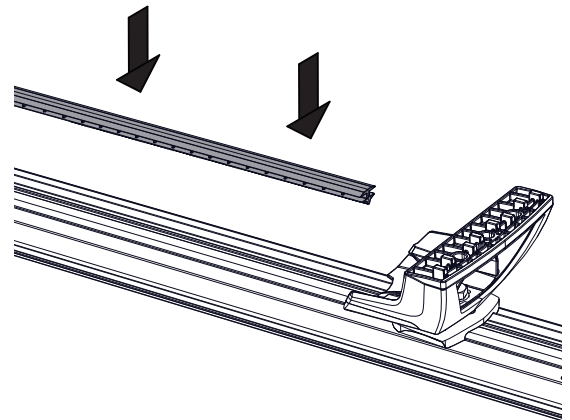
**28****BAR SLOT COVERS (OUTSIDE LEG)**

Measure the Bar channel outside of the Legs and subtract 20 mm from this measurement.

Using the remaining pieces of Slot Cover from the previous Step, cut to this length and press into the underside channel of each Bar end as shown.

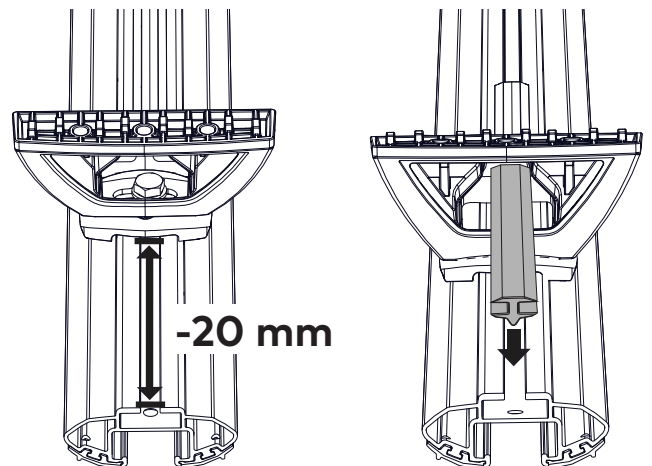
**29****SECURE END CAPS TO BARS**

Insert the End Caps as shown. A Rubber Mallet can be used to assist installation.

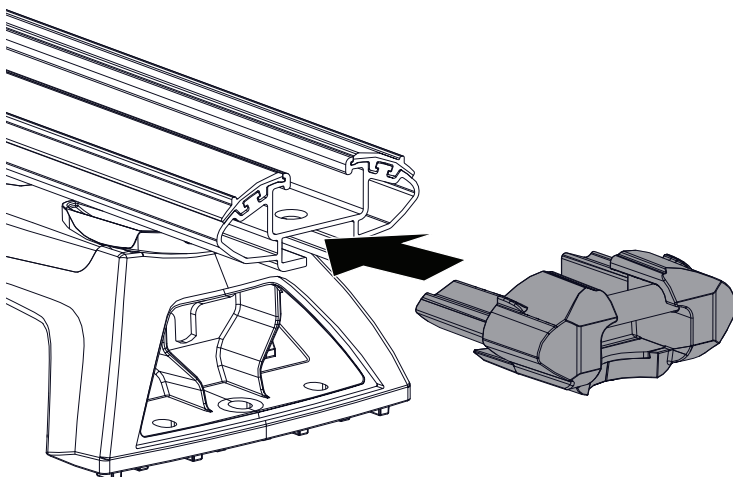
**30**

Secure using Plastite Screw (from LockNLoad Bar Kit). Tighten using a #2 Phillips Head Screwdriver.

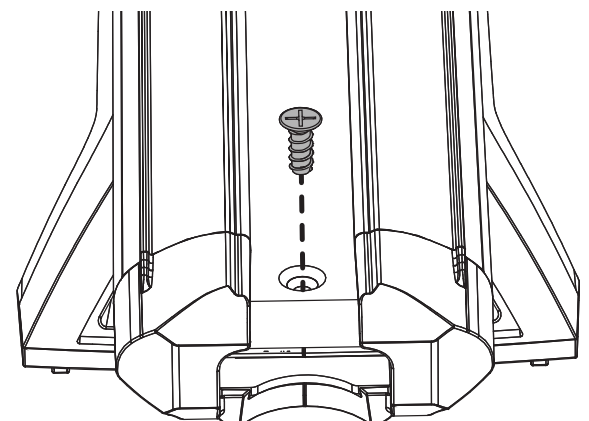

31

BAR FITMENT

Slide Nut Plates in Track into position for front and middle Bar placement, and Height Packers for rear Bar placement (it doesn't have to be exact). Place Bar assembly onto Tracks, carefully locating the raised notches on base of Legs into the cut outs on Height Packers and Nut Plates as shown.

Take care not to damage vehicle.

Repeat for all Bars.

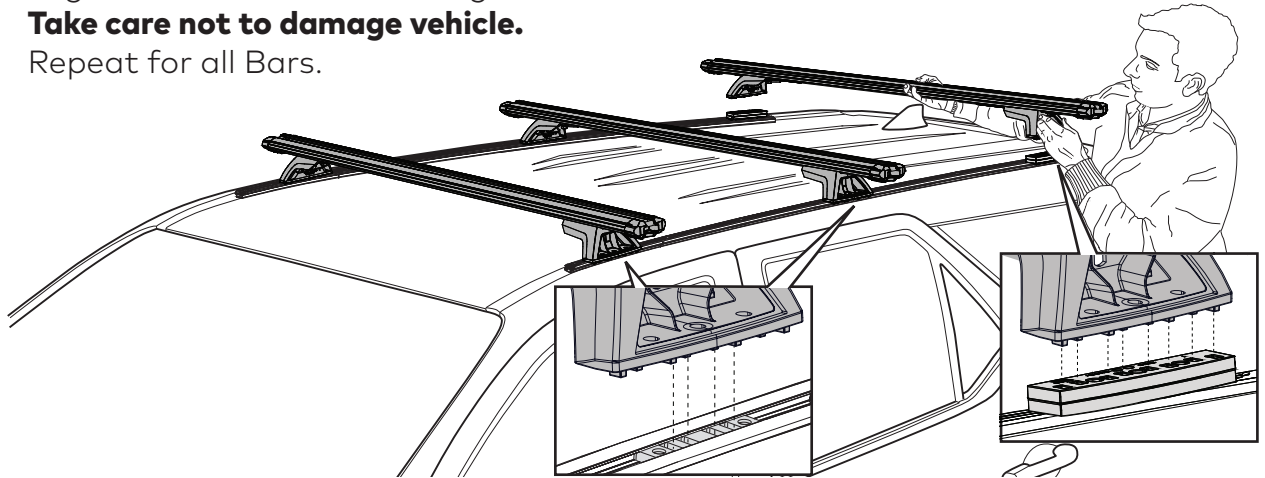

32

Position Bars along Tracks, ensuring there is a distance of 690 mm between each Bar.

Vehicle Front →

Measure from the centre of each Leg as shown.

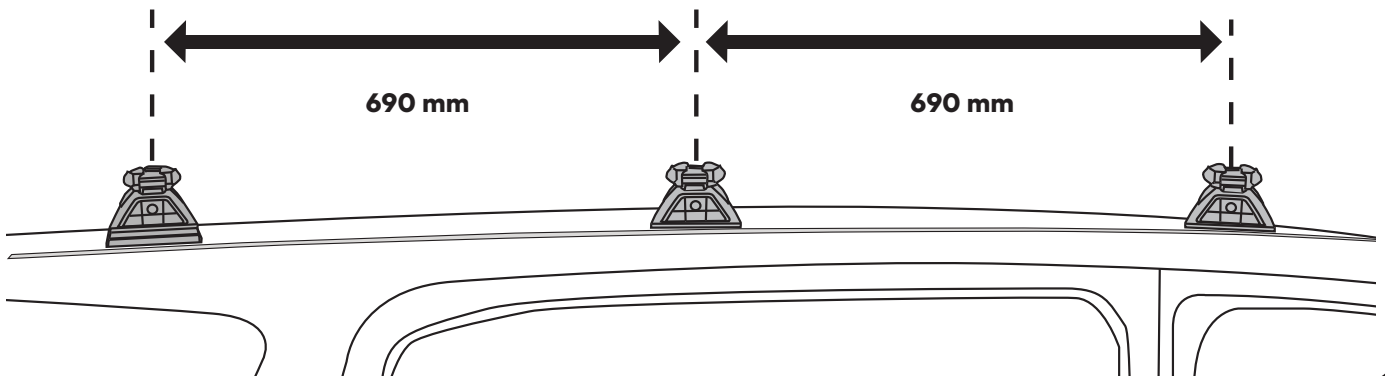

33

M6 HEX SCREW ASSEMBLY

From the LockNLoad Track Kit, assemble 1 x M6 Spring Washer and 1 x M6 Washer onto each M6 Hex Screw (20 mm and 30 mm). Insert through the outer holes on Legs into Height Packer as shown.

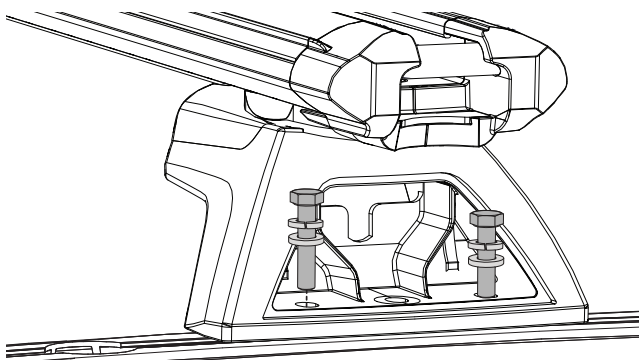

Front & Middle Legs

M6 Set Screw 20 mm

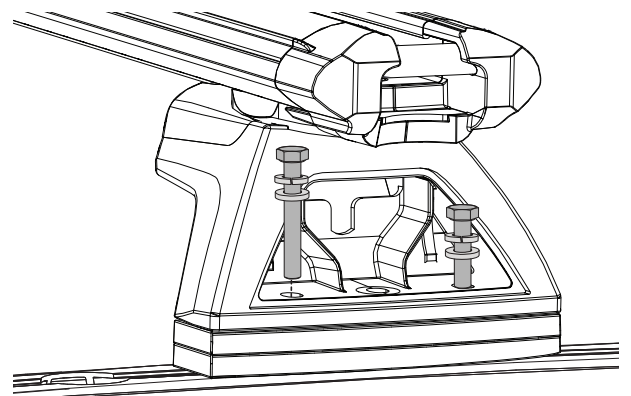

Rear Legs

M6 Set Screw 30 mm

34**SECURE BARS TO TRACKS**

Tighten all M6 Hex Screws to 5 Nm using a 10 mm Open Ended Spanner. **Do not over tighten.**

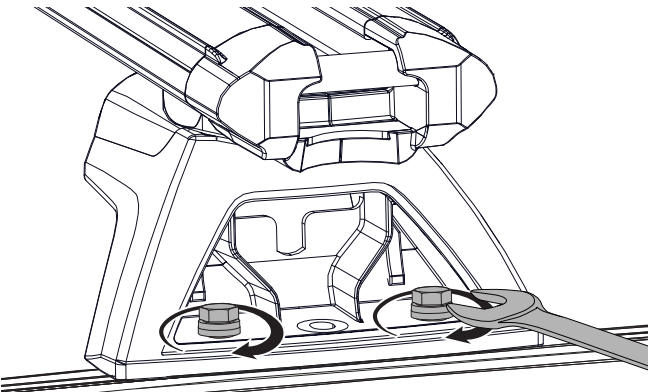
**35****CHECK BAR LEGS ARE SECURE**

Check all Bar Legs are secure.

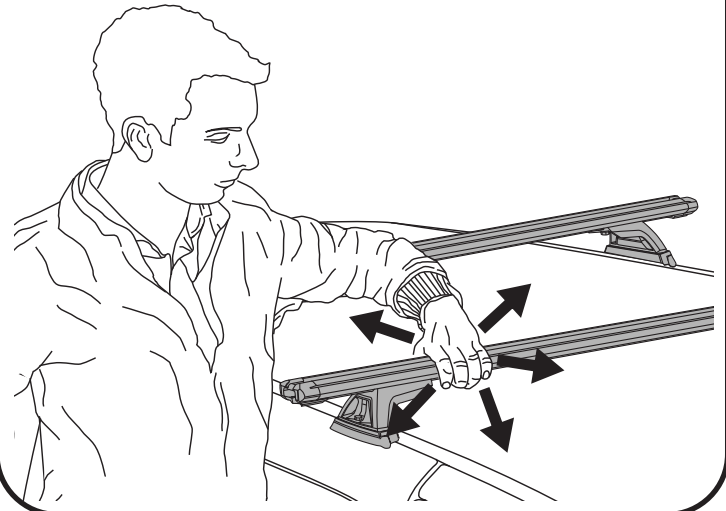
**36****FIT LEG COVERS**

Using the keys and Covers supplied in the LockNLoad Leg Kit, fit and lock all Leg Covers.

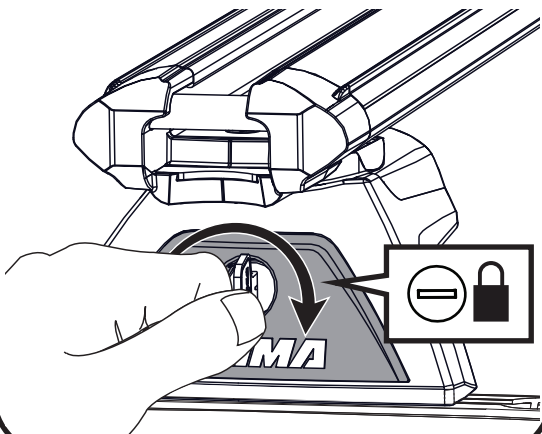
**37****BAR KEYS**

Place one key on the vehicle key ring and put the other away safely, or store with the spare vehicle key.

Write the key number (which is stamped on the key) in the box provided. Replacement keys are available from Yakima stockists, visit www.yakima.com.au or www.yakima.co.nz to find your nearest store or contact us directly on 1800 143 548 (AU) or 0800 4776 722 (NZ).

 | Key Number: |
 | |

YAKIMA

www.yakima.com.au

www.yakima.co.nz

www.yakima.com

www.yakima.eu

YAKIMA AUSTRALIA PTY LTD

17 Hinkler Court
Brendale, QLD 4500
Australia
1800 143 548

YAKIMA PRODUCTS, INC.

4101 Kruse Way
Lake Oswego, OR
97035-2541
USA
888 925 4621

ALL CONTENT SUBJECT TO YAKIMA AUSTRALIA PTY LTD COPYRIGHT © 2016