

YAKIMA Locking RailRider 3

US

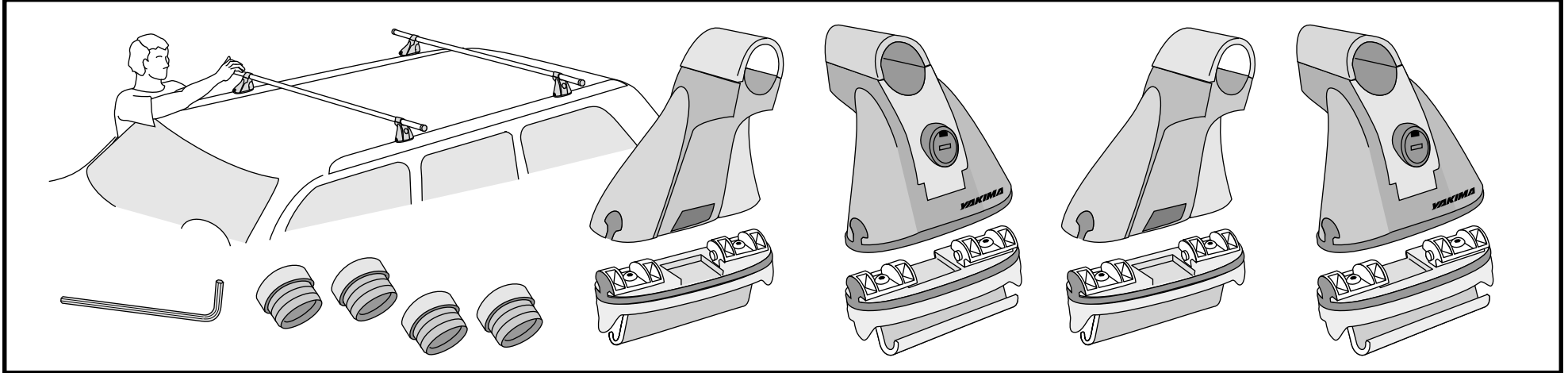

1 PRIOR TO INSTALLATION:

You must remove the racks which came with your car.

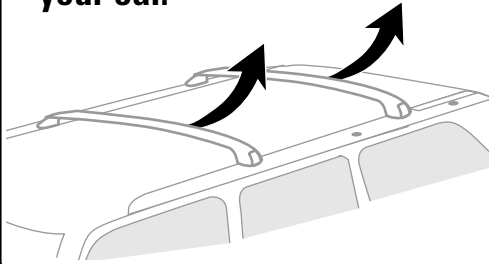

2 TO REMOVE FACTORY-INSTALLED RACKS:

- Open rear hatch door.
- Pry up the track cover-plate.

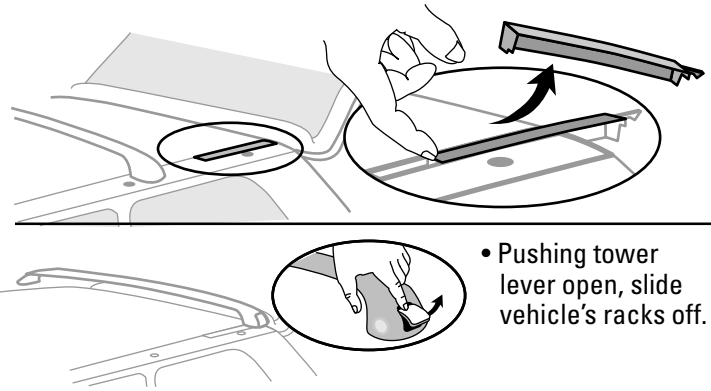

- Pushing tower lever open, slide vehicle's racks off.

3 INSTALL YOUR NEW RACKS:

Slide the loosened bases into the tracks. Be sure the "hook" faces away from the vehicle.

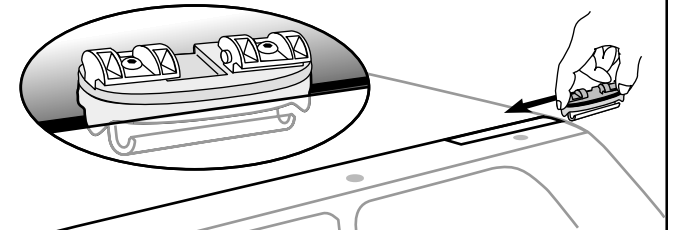

Note: If you have difficulty sliding the base within the track, a mixture of liquid soap and water can be used as lubricant.

4 Once you have determined your crossbar spread, measure for equal distances on both sides of the vehicle.

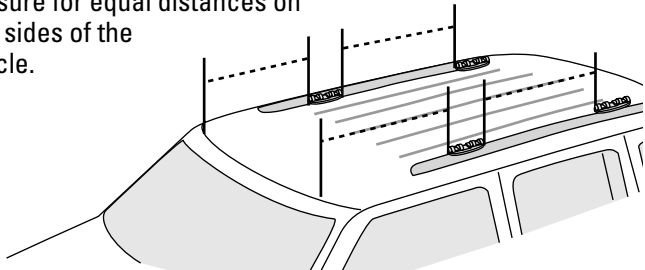

5 Tighten bases. Do not over-tighten the bases — the towers may have difficulty sliding on.

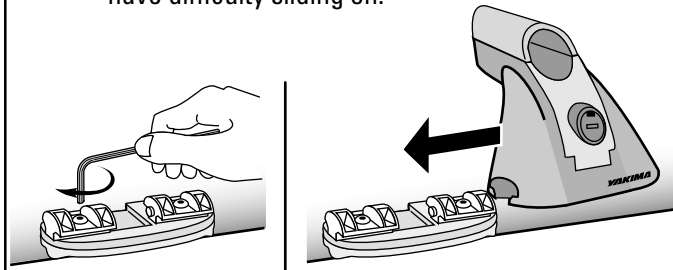

6 Open levers to loosen tower screws.

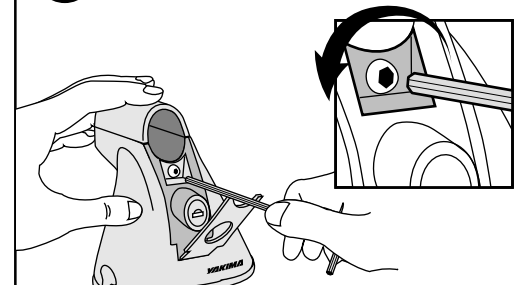

7 Slide towers onto crossbars.

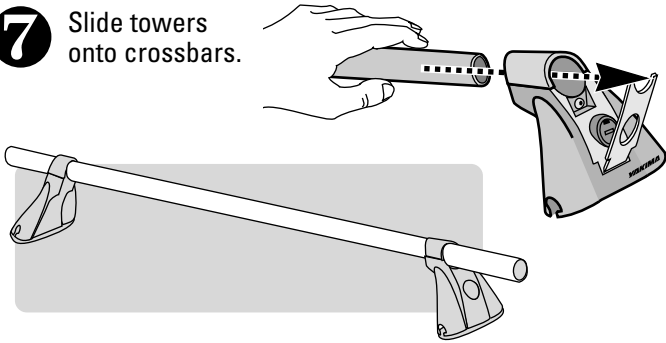

If crossbar will not slide in, loosen tower screw.

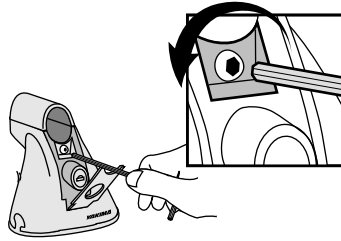

8 WITH LEVERS OPEN, slide towers onto bases.

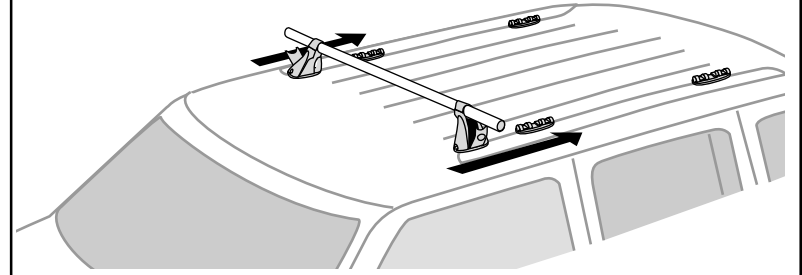

9 Tighten tower screws after crossbars are centered.

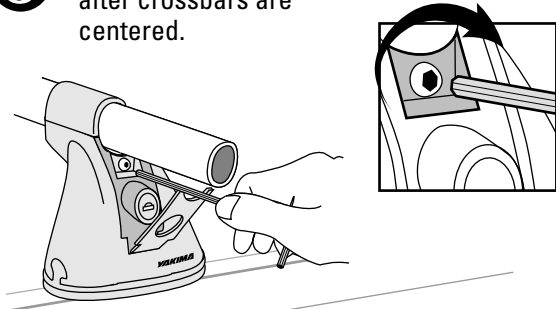

10 CLOSE levers on all towers.

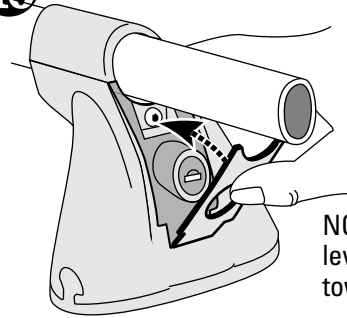

NOTE: Closing the levers secures towers to bases.

If lever **WILL NOT CLOSE COMPLETELY**—
make sure the base is aligned to the tower.

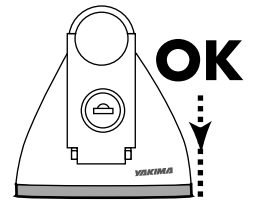
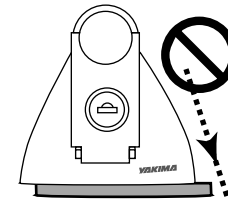

11 Install SKS® Locks (purchased separately) using lock instructions.

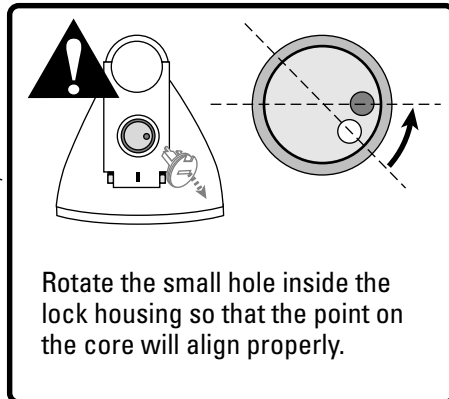
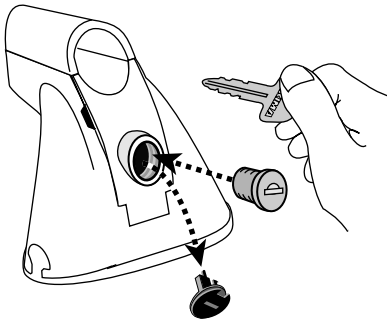

Rotate the small hole inside the lock housing so that the point on the core will align properly.

12 Install end caps on crossbars.

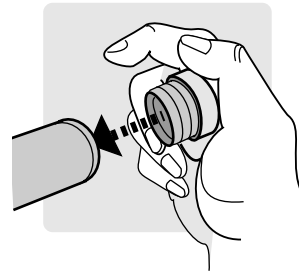

TEST INSTALLATION
by pulling on each tower and each bar.

Some play between tower and base is normal.

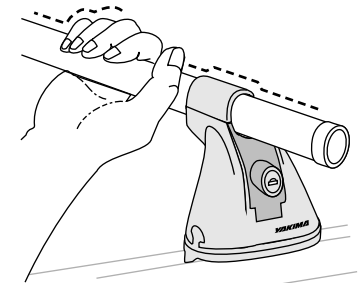

DO NOT EXCEED WEIGHT LIMIT OF 150 LBS.

SECURE LONG LOADS at the front and rear.

Part #1031734 RevA

YAKIMA Locking RailRider 3

FR

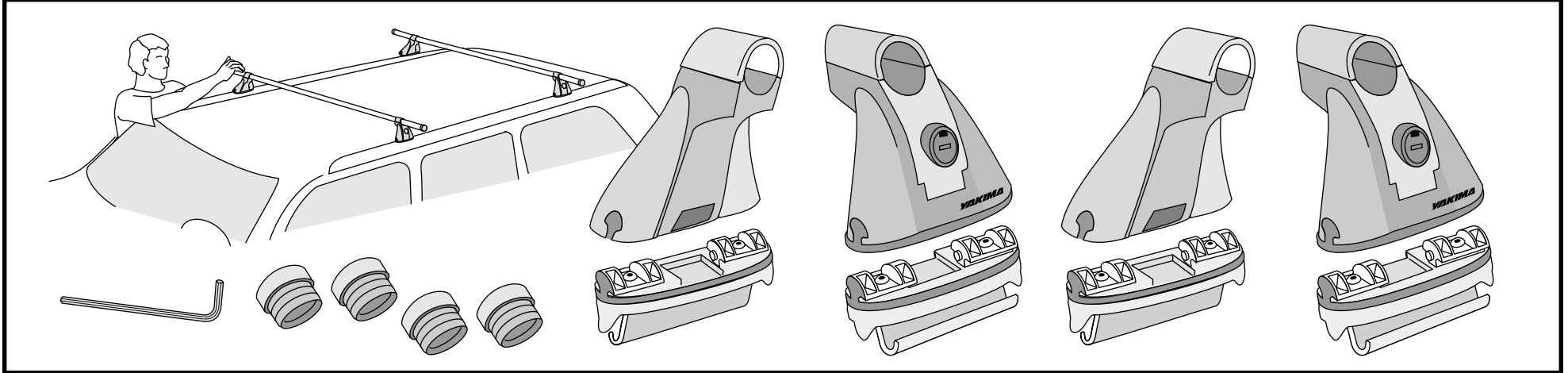

1 AVANT DE COMMENCER:

il est obligatoire d'enlever les barres transversales d'origine.

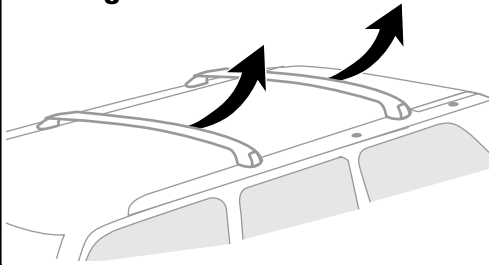

2 POUR EVLEVER LE PORTE-BAGAGES D'ORIGINE:

- Ouvrir le hayon.
- Extraire la plaquette recouvrant la glissière

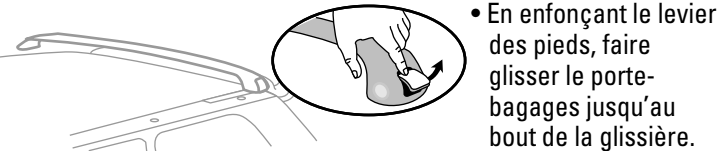
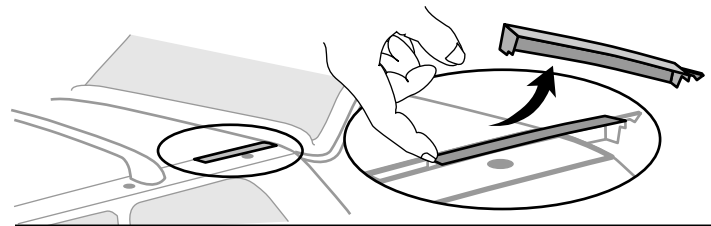

- En enfonçant le levier des pieds, faire glisser le porte-bagages jusqu'au bout de la glissière.

3 POUR POSER LES NOUVELLES BARRES TRANSVERSALES:

- Glisser les patins, boulons desserrés, dans les glissières.
- S'assurer que le rebord formant crochet est bien tourné vers l'extérieur du véhicule.

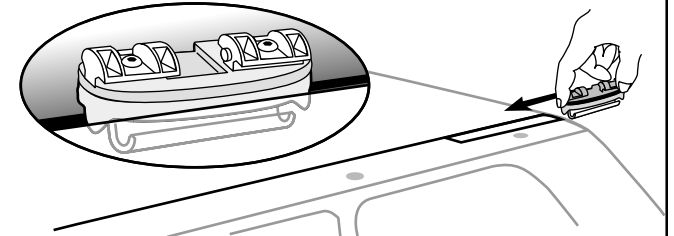

Remarque: si le patin glisse mal dans la glissière, appliquer de l'eau savonneuse comme lubrifiant.

4

Une fois déterminée la distance entre les barres transversales, mesurer de manière à disposer les patins symétriquement des deux côtés du véhicule.

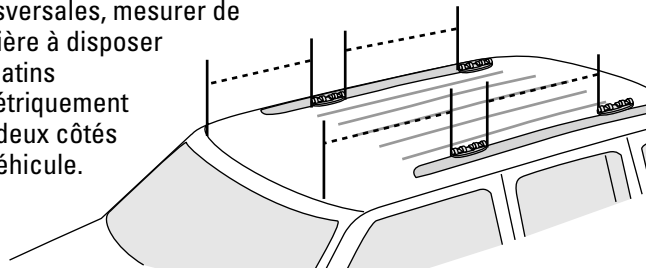

5

Ne serrer les patins qu'au point de sentir une certaine résistance. Ne pas trop serrer les patins, car les les pieds deviendraient difficiles à engager.

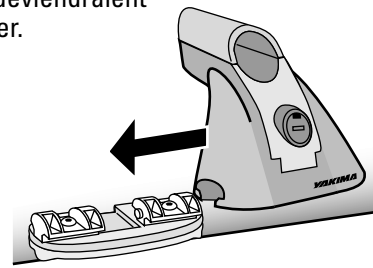
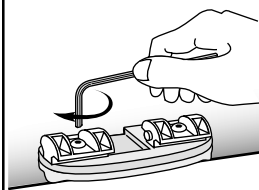

6

Pour chaque pied, ouvrir le levier et desserrer la vis de blocage.

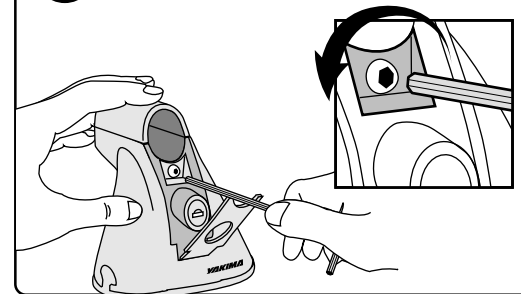

7 Enfiler les pieds sur les barres transversales.

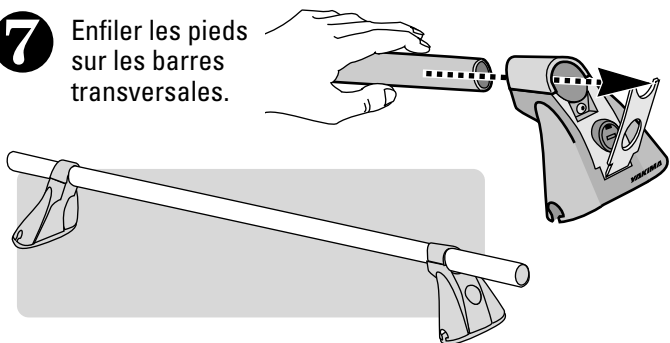

Si la barre ne passe pas, desserrer la vis un peu plus.

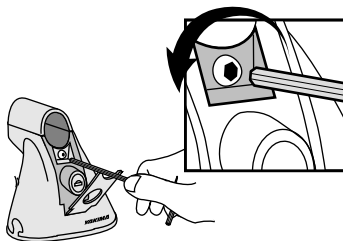

8 AVEC LES LEVIERS OUVERTS, engager les pieds sur les patins en les faisant coulisser.

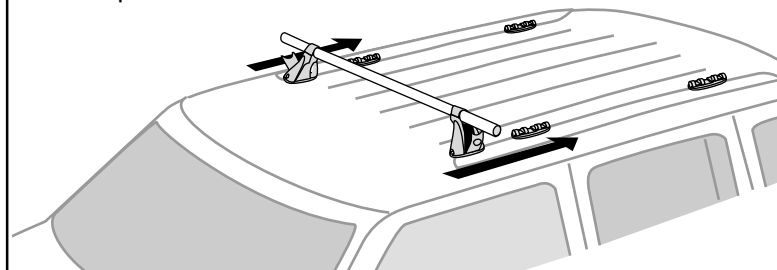

9 Une fois les barres transversales centrées, serrer les vis de blocage.

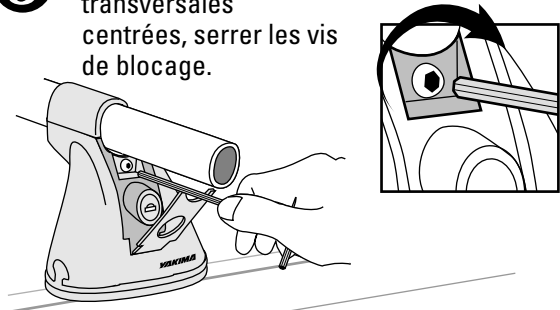

10 RABATTRE les leviers des quatre pieds.

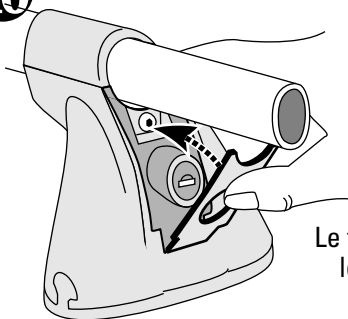

REMARQUE:
Le fait de rabattre le levier verrouille le pied au patin.

Si le levier **NE SE RABAT PAS COMPLÈTEMENT**, vérifier que le pied et le patin sont bien alignés.

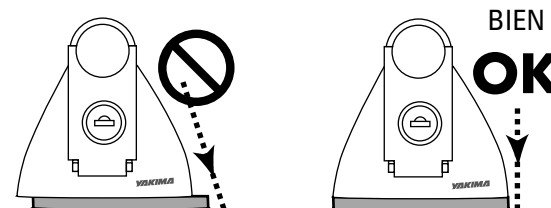

11 Installer les serrures SKS® (achetées à part) en suivant les instructions qui les accompagnent.

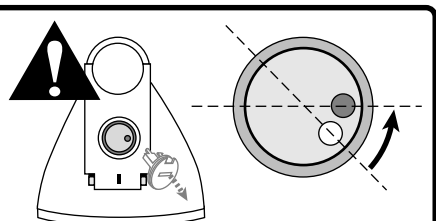
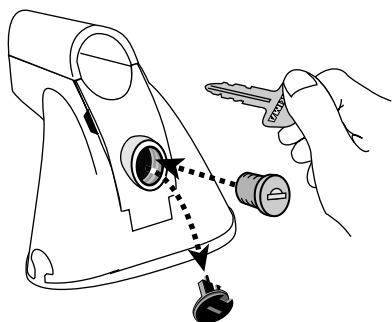

Faire tourner le petit trou au fond du logement de la serrure de manière que l'ergot de la serrure s'y engage bien.

12 Poser les bouchons d'extrémité sur les barres.

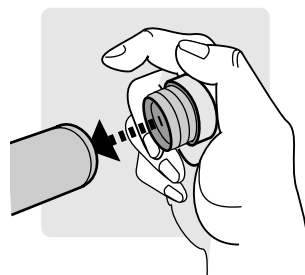

VÉRIFIER LE MONTAGE en essayant de faire bouger chaque pied et chaque barre.

Il est normal qu'il y ait un peu de jeu entre le pied et le patin.

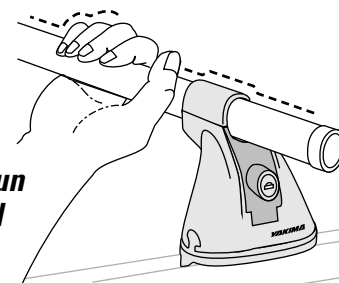

NE PAS DÉPASSER LA CHARGE MAXIMALE DE 70 KG (150 LB).

ATTACHER LES CHARGES LONGUES à l'avant et à l'arrière.

YAKIMA Locking RailRider 3

ES

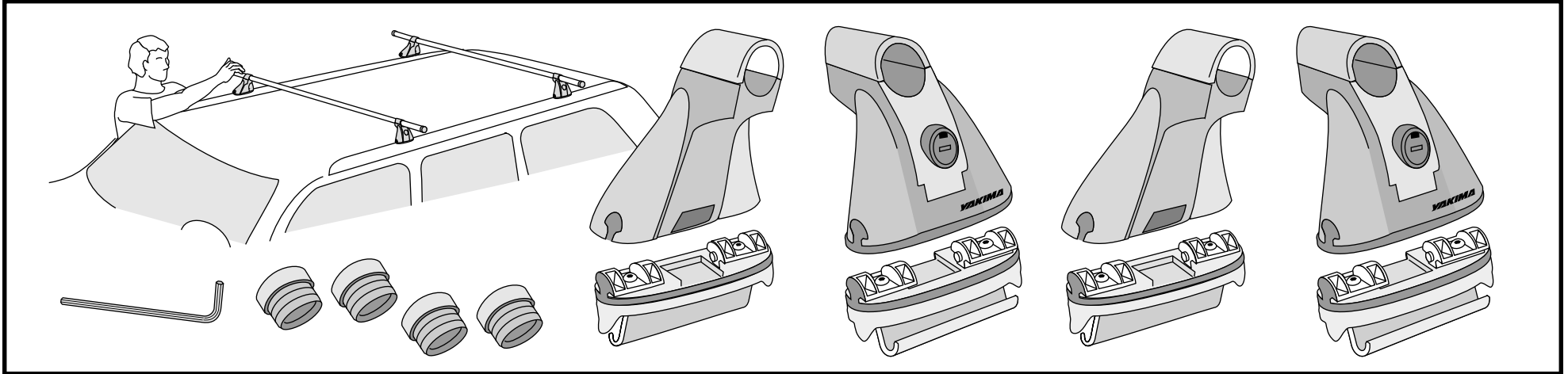

1 ANTES DE LA INSTALACIÓN:

Deben quitarse los travesaños que vinieron con su vehículo.

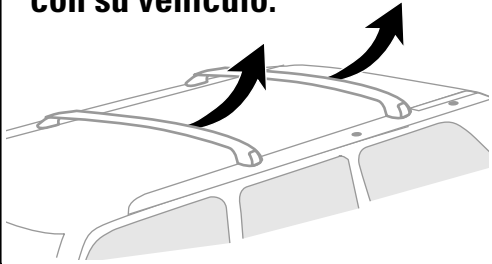

2 PARA QUITAR LA PARRILLA INSTALADA DE FÁBRICA:

- Abra la puerta trasera.
- Levante la plaqueta que cubre el riel.

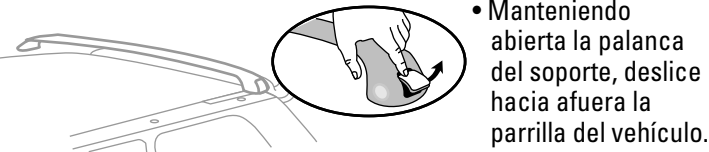
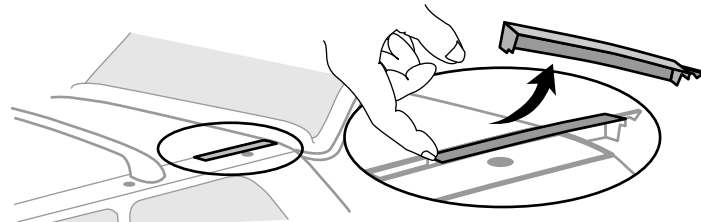

- Manteniendo abierta la palanca del soporte, deslice hacia afuera la parrilla del vehículo.

3 INSTALE SU PARRILLA NUEVA:

Deslice en los rieles las bases flojas. Cerciórese de que el "gancho" apunta hacia fuera del vehículo.

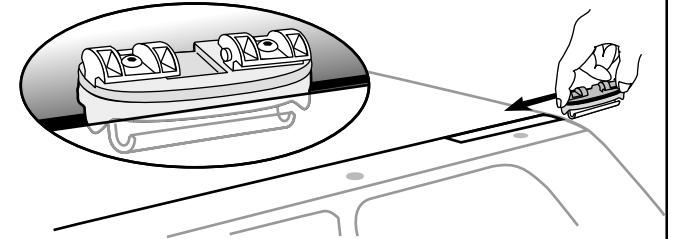

Nota: Si encuentra dificultad la base en riel, puede usar como lubricante una mezcla de jabón líquido.

4 Una vez determinada la separación entre travesaños, mida iguales distancias a ambos lados del vehículo.

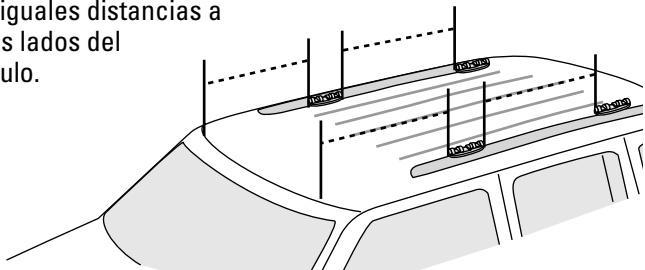

5 Ajuste las bases hasta sentir cierta resistencia. No ajuste demasiado las bases pues podría ser difícil deslizar los soportes.



6 Abra las palancas para aflojar los tornillos del soporte.

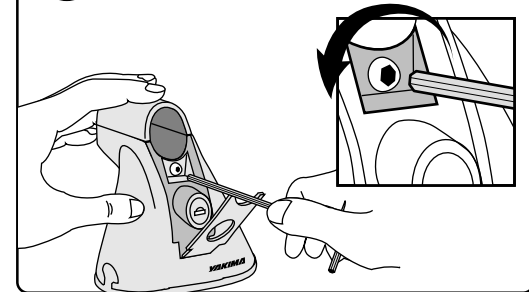

7 Deslice los soportes sobre los travesaños.

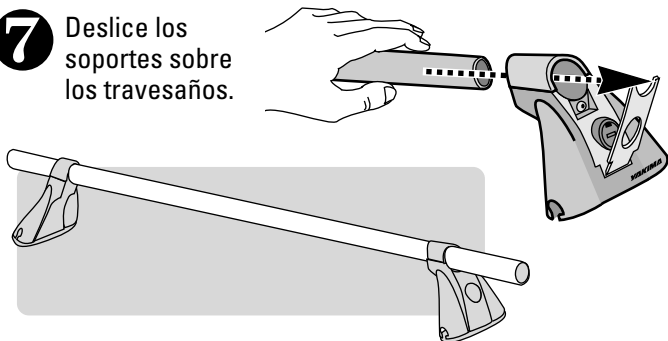

Si el travesaño no entra bien, afloje el tornillo del soporte.

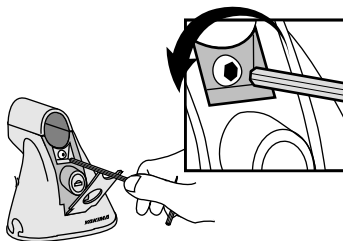

8 CON LAS PALANCAS ABIERTAS, deslice los soportes sobre las bases.

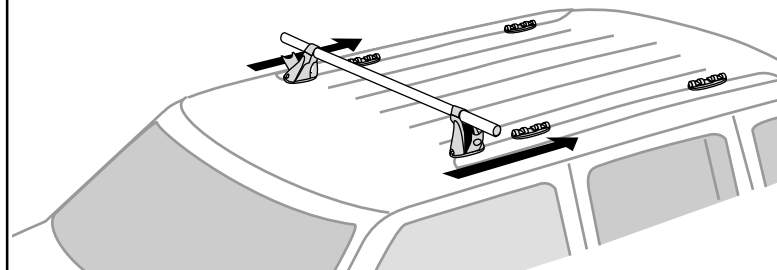

9 Ajuste los tornillos de los soportes después de centrar los travesaños.

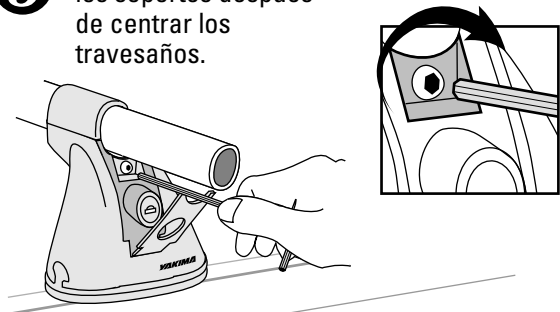

10 CIERRE las palancas en todos los soportes.



Si la palanca **NO CIERRA COMPLETAMENTE**— asegúrese de que la base está alineada con la torre.

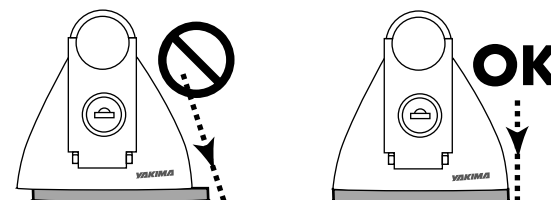

11 Instale los cerrojos SKS® Locks (se compran por separado) siguiendo las instrucciones correspondientes.

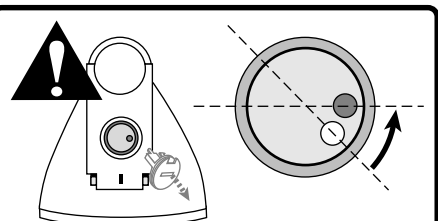
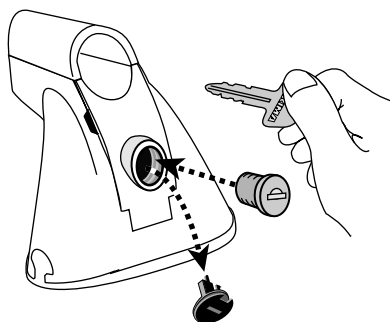

Gire el pequeño orificio dentro de la caja del cerrojo para que coincida exactamente con el punto en el núcleo.

12 Instale los casquetes en los extremos de los travesaños.

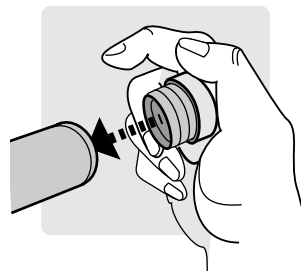

COMPRUEBE LA INSTALACIÓN tirando de cada soporte y de cada travesaño.

Es normal que haya algún juego entre el soporte y la base

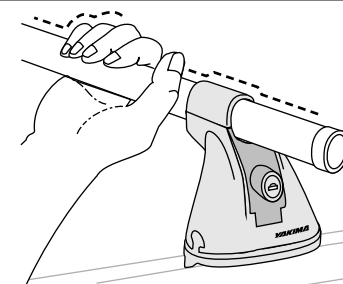

NO EXCEDA EL LÍMITE DE PESO DE 70 KG (150 LIBRAS).

ASEGURE LAS CARGAS LARGAS a la parte anterior y posterior del vehículo.