

# YAKIMA Wing & Locking RailRider Fit Sheet

## IF YOU NEED TO INSTALL ADDITIONAL PLATES:

Use the plates for your vehicle in the list below.

Position the plates so that they fit tightly inside the tracks.

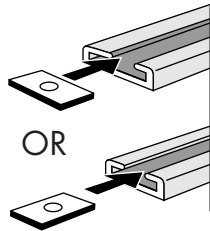

NOTE: Installation of additional plates may require removal of track end caps, covers, or crossbars. Tools may be required. Refer to owner's manual for details on factory rack removal.

## CAUTION:

If recommended screws seem too short and are not engaging the plates...

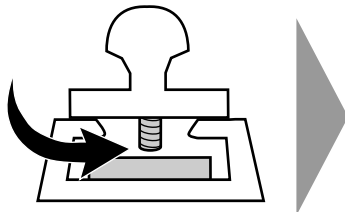

ASSEMBLE plates, screws, and bases before sliding into open end of tracks.

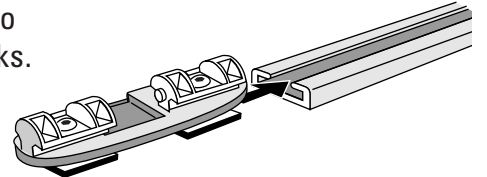

## Locking RailRider 1:

MAKE	MODEL	YEAR	PLATE	SCREW	WEIGHT LIMIT	NOTE
BMW	5 Series Wagon	92-95	B	SHORT	165 lbs./75 kg	
BUICK	Roadmaster Wagon	91-96	A	LONG	165 lbs./75 kg	
CHEVROLET	Caprice Wagon	91-93	A	LONG	165 lbs./75 kg	
CHEVROLET /GMC TRUCKS	Lumina Van	90-96	A	SHORT	125 lbs./56 kg	Loads limited to bikes, skis, and BasketCase
DODGE	Colt Wagon	92-94	A	SHORT	100 lbs./45 kg	Loads limited to bikes, skis, and BasketCase
EAGLE	Summit Wagon	92-95	A	SHORT	100 lbs./45 kg	Loads limited to bikes, skis, and BasketCase
FORD	Aerostar Van	86-97	A	SHORT	100 lbs./45 kg	
	Bronco II	83-90	A	SHORT	100 lbs./45 kg	
	Escape	01	A	SHORT	165 lbs./75kg	
	Excursion	00	A	SHORT	165lbs./75kg	
	Expedition	97-00	A	SHORT	165 lbs./75 kg	
	Explorer 2dr/4dr	91-00	A	SHORT	165 lbs./75 kg	
	Taurus Wagon	96-00	A	SHORT	100 lbs./45 kg	
	Taurus Wagon	86-95	B	SHORT	165 lbs./75 kg	
	Windstar	98-00	A	SHORT	165 lbs./75 kg	
HONDA	Passport	94-97	A	SHORT	100 lbs./45 kg	
INFINITI	QX4	97-00	⚠ see note	LONG	100 lbs./45 kg	⚠ You must use existing plates. Remove factory crossbars and slats.
JEEP	Cherokee/Wagoneer	84-90	A	LONG	150 lbs./68 kg	
MAZDA	MPV	89-91	A	SHORT	100 lbs./45 kg	
	Navajo	91-94	A	SHORT	100 lbs./45 kg	
MERCURY	Sable Wagon	96-00	A	SHORT	100 lbs./45 kg	
	Sable Wagon	86-95	B	SHORT	165 lbs./75 kg	
	Villager Van	93-00	A	SHORT	100 lbs./45 kg	
MITSUBISHI	Montero Sport	97-00	A	SHORT	100 lbs./45 kg	
NISSAN	Axxess	89-93	A	SHORT	80 lbs./36 kg	Loads limited to bikes, skis, and BasketCase
	Pathfinder 4dr	97-99	⚠ see note	LONG	100 lbs./45 kg	⚠ You must use existing plates. Remove factory crossbars and slats.
	Pathfinder 4dr	99.5-00	⚠ see note	LONG	165 lbs./75 kg	⚠ You must use existing plates. Remove factory crossbars and slats.
	Pathfinder 4dr	90-95	A	SHORT	80 lbs./36 kg	
	Quest Van	93-99	A	SHORT	100 lbs./45 kg	
	Quest Van	99-00	A	SHORT	100 lbs./45kg	
OLDSMOBILE	Bravada	91-94	A	SHORT	165 lbs./75 kg	
	Custom Cruiser Wagon	91-92	A	LONG	165 lbs./75 kg	
	Silhouette	90-96	A	SHORT	125 lbs./56 kg	Loads limited to bikes, skis, and BasketCase
PLYMOUTH	Colt Vista Wagon	92-94	A	SHORT	100 lbs./45 kg	Loads limited to bikes, skis, and BasketCase
PONTIAC	Transport Van	90-96	A	SHORT	125 lbs./56 kg	Loads limited to bikes, skis, and BasketCase
SUBARU	Loyale Wagon	90-94	A	SHORT	100 lbs./45 kg	
	Wagon	85-89	A	SHORT	100 lbs./45 kg	
TOYOTA	4-Runner 2dr/4dr	90-99	A	SHORT	100 lbs./45 kg	
	Corolla Wagon/Altrac	88-96	A	SHORT	100 lbs./45 kg	Loads limited to bikes, skis, and BasketCase

## Locking RailRider 2:

MAKE	MODEL	YEAR	PLATE	SCREW	WEIGHT LIMIT	NOTE
ISUZU	Rodeo	91-97	—	—	100 lbs./45 kg	
JEEP	Cherokee	91-99	—	—	150 lbs./68 kg	
	Grand Cherokee	93-98	—	—	150 lbs./68 kg	
	Grand Wagoneer	93-95	—	—	150 lbs./68 kg	
	Wagoneer	91-98	—	—	150 lbs./68 kg	
KIA	Sportage 4dr	95-00	—	—	100 lbs./45 kg	

If you do not find your vehicle listed, contact your Yakima dealer.

# YAKIMA Feuille de compatibilité

## S'IL FAUT AJOUTER DES PLAQUETTES:

Dans le tableau ci-dessous, choisir les plaquettes recommandées pour le véhicule.

Placer les plaquettes de manière qu'elles s'ajustent bien dans la glissière.

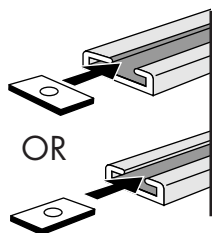

REMARQUE: Pour poser des plaquettes supplémentaires, il faudra peut-être enlever les bouchons d'extrémité, des garnitures ou les barres transversales de la glissière d'origine, et employer des outils. Consulter le manuel du propriétaire pour savoir comment enlever le porte-bagages d'origine.

## ATTENTION:

Si les vis recommandées semblent trop courtes pour s'engager dans les plaquettes...

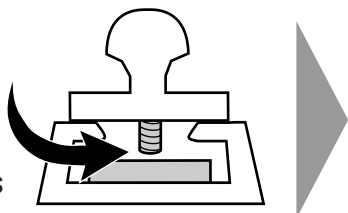

ASSEMBLER les plaquettes, les vis et les patins avant de les glisser par le bout de la glissière.

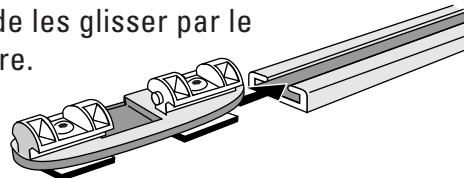

## Locking RailRider1:

MARQUE	MODULE	ANNÉE	PLAQUETTE	VIS	CHARGE MAXIMALE	REMARQUE
BMW	5 Series Wagon	92-95	B	COURTE	165 lbs./75 kg	
BUICK	Roadmaster Wagon	91-96	A	LONGUE	165 lbs./75 kg	
CHEVROLET	Caprice Wagon	91-93	A	LONGUE	165 lbs./75 kg	
CHEVROLET /GMC TRUCKS	Lumina Van	90-96	A	COURTE	125 lbs./56 kg	La charge doit se limiter à des vélos, des skis et un panier BasketCase.
DODGE	Colt Wagon	92-94	A	COURTE	100 lbs./45 kg	La charge doit se limiter à des vélos, des skis et un panier BasketCase.
EAGLE	Summit Wagon	92-95	A	COURTE	100 lbs./45 kg	La charge doit se limiter à des vélos, des skis et un panier BasketCase.
FORD	Aerostar Van	86-97	A	COURTE	100 lbs./45 kg	
	Bronco II	83-90	A	COURTE	100 lbs./45 kg	
	Escape	01	A	COURTE	165 lbs./75 kg	
	Excursion	00	A	COURTE	165 lbs./75 kg	
	Expedition	97-00	A	COURTE	165 lbs./75 kg	
	Explorer 2 p./4 p.	91-00	A	COURTE	165 lbs./75 kg	
	Taurus Wagon	96-00	A	COURTE	100 lbs./45 kg	
	Taurus Wagon	86-95	B	COURTE	165 lbs./75 kg	
	Windstar	98-00	A	COURTE	165 lbs./75 kg	
HONDA	Passport	94-97	A	COURTE	100 lbs./45 kg	
INFINITI	QX4	97-00	⚠️ Voire remarque	LONGUE	100 lbs./45 kg	⚠️ Employer obligatoirement les plaquettes d'origine. Enlever les barres transversales et les garnitures d'origine.
JEEP	Cherokee/Wagoneer	84-90	A	LONGUE	150 lbs./68 kg	
MAZDA	MPV	89-91	A	COURTE	100 lbs./45 kg	
	Navajo	91-94	A	COURTE	100 lbs./45 kg	
MERCURY	Sable Wagon	96-00	A	COURTE	100 lbs./45 kg	
	Sable Wagon	86-95	B	COURTE	165 lbs./75 kg	
	Villager Van	93-00	A	COURTE	100 lbs./45 kg	
MITSUBISHI	Montero Sport	97-00	A	COURTE	100 lbs./45 kg	
NISSAN	Axxess	89-93	A	COURTE	80 lbs./36 kg	La charge doit se limiter à des vélos, des skis et un panier BasketCase.
	Pathfinder 4 p.	97-99	⚠️ Voire remarque	LONGUE	100 lbs./45 kg	⚠️ Employer obligatoirement les plaquettes d'origine. Enlever les barres transversales et les garnitures d'origine.
	Pathfinder 4 p.	99.5-00		LONGUE	165 lbs. / 75kg	
	Pathfinder 4 p.	90-95	A	COURTE	80 lbs./36 kg	
	Quest Van	93-98	A	COURTE	100 lbs./45 kg	
	Quest Van	99-00	A	COURTE	100 lbs./45 kg	
OLDSMOBILE	Bravada	91-94	A	COURTE	165 lbs./75 kg	
	Custom Cruiser Wagon	91-92	A	LONGUE	165 lbs./75 kg	
	Silhouette	90-96	A	COURTE	125 lbs./56 kg	La charge doit se limiter à des vélos, des skis et un panier BasketCase.
PLYMOUTH	Colt Vista Wagon	92-94	A	COURTE	100 lbs./45 kg	La charge doit se limiter à des vélos, des skis et un panier BasketCase.
PONTIAC	Transport Van	90-96	A	COURTE	125 lbs./56 kg	La charge doit se limiter à des vélos, des skis et un panier BasketCase.
SUBARU	Loyale Wagon	90-94	A	COURTE	100 lbs./45 kg	
	Wagon	85-89	A	COURTE	100 lbs./45 kg	
TOYOTA	4-Runner 2p./4 p.	90-99	A	COURTE	100 lbs./45 kg	
	Corolla Wagon/Altrac	88-96	A	COURTE	100 lbs./45 kg	La charge doit se limiter à des vélos, des skis et un panier BasketCase.

## Locking RailRider2:

MARQUE	MODULE	ANNÉE	PLAQUETTE	VIS	CHARGE MAXIMALE	REMARQUE
ISUZU	Rodeo	91-97	—	—	100 lbs./45 kg	
JEEP	Cherokee	91-99	—	—	150 lbs./68 kg	
	Grand Cherokee	93-98	—	—	150 lbs./68 kg	
	Grand Wagoneer	93-95	—	—	150 lbs./68 kg	
	Wagoneer	91-98	—	—	150 lbs./68 kg	
KIA	Sportage 4 p.	95-00	—	—	100 lbs./45 kg	

Si votre véhicule ne figure pas dans le tableau, consulter votre dépositaire Yakima.

# YAKIMA Hoja de compatibilidad

## SI DEBE INSTALAR MÁS PLAQUETAS:

Use las plaquetas indicadas en la lista.

Coloque las plaquetas para que encajen justo en los rieles.

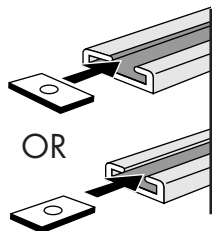

NOTA: La instalación de más plaquetas puede requerir la extracción de casquetes de riel, recubrimientos o travesaños y usar herramientas. Busque en el manual del propietario instrucciones para quitar la parrilla de fábrica.

## ATENCIÓN:

Si los tornillos recomendados parecen demasiado cortos y no llegan a las plaquetas...

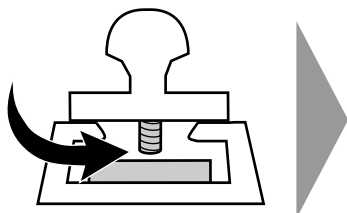

MONTE plaquetas, tornillos y bases antes de insertar en el extremo abierto del riel.

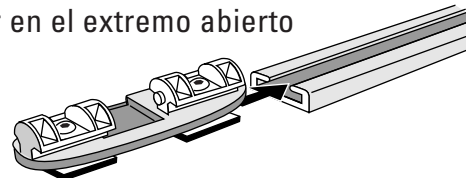

## Locking RailRider1:

MARCA	MODELO	AÑO	PLAQUETA	TORNILLO	PESO LÍMITE	NOTA
BMW	5 Series Wagon	92-95	B	CORTO	165 lbs./75 kg	
BUICK	Roadmaster Wagon	91-96	A	LARGO	165 lbs./75 kg	
CHEVROLET	Caprice Wagon	91-93	A	LARGO	165 lbs./75 kg	
CHEVROLET /GMC TRUCKS	Lumina Van	90-96	A	CORTO	125 lbs./56 kg	Cargas limitadas a bicicletas, esquís y BasketCase.
DODGE	Colt Wagon	92-94	A	CORTO	100 lbs./45 kg	Cargas limitadas a bicicletas, esquís y BasketCase.
EAGLE	Summit Wagon	92-95	A	CORTO	100 lbs./45 kg	Cargas limitadas a bicicletas, esquís y BasketCase.
FORD	Aerostar Van	86-97	A	CORTO	100 lbs./45 kg	
	Bronco II	83-90	A	CORTO	100 lbs./45 kg	
	Escape	01	A	CORTO	165 lbs./75kg	
	Excursion	00	A	CORTO	165 lbs./75 kg	
	Expedition	97-00	A	CORTO	165 lbs./75 kg	
	Explorer 2 p./4 p.	91-00	A	CORTO	165 lbs./75 kg	
	Taurus Wagon	96-00	A	CORTO	100 lbs./45 kg	
	Taurus Wagon	86-95	B	CORTO	165 lbs./75 kg	
	Windstar	98-00	A	CORTO	165 Lbs./75 kg	
HONDA	Passport	94-97	A	CORTO	100 lbs./45 kg	
INFINITI	QX4	97-00	▲ Véase nota	LARGO	100 lbs./45 kg	▲ Deben usarse las plaquetas existentes. Quite travesaños y listones de fábrica.
JEEP	Cherokee/Wagoneer	84-90	A	LARGO	150 lbs./68 kg	
MAZDA	MPV	89-91	A	CORTO	100 lbs./45 kg	
	Navajo	91-94	A	CORTO	100 lbs./45 kg	
MERCURY	Sable Wagon	96-98	A	CORTO	100 lbs./45 kg	
	Sable Wagon	86-95	B	CORTO	165 lbs./75 kg	
	Villager Van	93-00	A	CORTO	100 lbs./45 kg	
MITSUBISHI	Montero Sport	97-00	A	CORTO	100 lbs./45 kg	
NISSAN	Axxess	89-93	A	CORTO	80 lbs./36 kg	Cargas limitadas a bicicletas, esquís y BasketCase.
	Pathfinder 4 p.	97-99	▲ Véase nota	LARGO	100 lbs./45 kg	▲ Deben usarse las plaquetas existentes. Quite travesaños y listones de fábrica.
	Pathfinder 4 p.	99.5-00			165 lbs./75 kg	
	Pathfinder 4 p.	90-95	A	CORTO	80 lbs./36 kg	
	Quest Van	93-98	A	CORTO	100 lbs./45 kg	
	Quest Van	99-00	A	CORTO	100 lbs./45 kg	
OLDSMOBILE	Bravada	91-94	A	CORTO	165 lbs./75 kg	
	Custom Cruiser Wagon	91-92	A	LARGO	165 lbs./75 kg	
	Silhouette	90-96	A	CORTO	125 lbs./56 kg	Cargas limitadas a bicicletas, esquís y BasketCase.
PLYMOUTH	Colt Vista Wagon	92-94	A	CORTO	100 lbs./45 kg	Cargas limitadas a bicicletas, esquís y BasketCase.
PONTIAC	Transport Van	90-96	A	CORTO	125 lbs./56 kg	Cargas limitadas a bicicletas, esquís y BasketCase.
SUBARU	Loyale Wagon	90-94	A	CORTO	100 lbs./45 kg	
	Wagon	85-89	A	CORTO	100 lbs./45 kg	
TOYOTA	4-Runner 2 p./4 p.	90-99	A	CORTO	100 lbs./45 kg	
	Corolla Wagon/Altrac	88-96	A	CORTO	100 lbs./45 kg	Cargas limitadas a bicicletas, esquís y BasketCase.

## Locking RailRider2:

MARCA	MODELO	AÑO	PLAQUETA	TORNILLO	PESO LÍMITE	NOTA
ISUZU	Rodeo	91-97	—	—	100 lbs./45 kg	
JEEP	Cherokee	91-99	—	—	150 lbs./68 kg	
	Grand Cherokee	93-98	—	—	150 lbs./68 kg	
	Grand Wagoneer	93-95	—	—	150 lbs./68 kg	
	Wagoneer	91-98	—	—	150 lbs./68 kg	
KIA	Sportage 4 p.	95-00	—	—	100 lbs./45 kg	

Si su vehículo no aparece en la lista, comuníquese con su concesionario Yakima.